



Big 1/32 scale · Authentic Surface Details · Over Half Million Rivets · Highly Detailed Wright R2600 Radial Engines · Detail Cockpit and Bomb bay · Colourful Marking

Plastic model kit containing 521 parts

Wing span : 643mm Length : 540.5mm

The B-25, built to honor the memory of General Billy Mitch, was one of the most famous twin-engine US bombers of World War II. The Strafer was the brainchild of Colonel Gunn, ‘Pappy Gunn!’ Extensive information can now be obtained through the internet, so we don’t want to bore our patrons with a short form historical-lite account. Let’s get right into building this model, one of the best surface-detailed B-25s we’ve ever been able to offer.

CAUTION

- * When you use glue or paint, do not use near a naked flame, and use in a well-ventilated room.
- * Symbols such as ① refer to the color number of MR. COLOR and TAMIYA paints. Glue and paint are not included.
- * When you take parts off the runner frame, use modeling scissors and trim excess plastic with a cutter or a file.
- * See below for the meaning of symbols.

The instruction was written based on an experienced modeller's recommendation. We do understand while there are one or two logical sequence of assembly, each and every modellers have their own interpretations of order of building and painting. Therefor we recommended strongly that every proud owner of this giant kit study the instruction thoroughly, then follow their own ways and sequences in assembling and painting the model. Like many scale plastic kits in the market, this kit built around subassemblies. This is the best way to facilitate maximum ease of assembling and painting. Point to take special note is because the kit tried to depict the gear down position as accurate as possible, one must follow the instruction in installing the landing gear struts. Finally we must advice be very careful with the using of sharp tools such as modelling knives, drills and cutters. Photo etch pieces are included so also be very careful with the use of super glue. It tend to stick your fingers together if used improperly. If that should happen, don't attempt tearing the fingers apart by brutal force. Use de-bonder from the super glue family to de-solve the glue or simply let the figure stick together for a short period of time and they should come apart with the help of the metabolism of the human skin. There are many model paint in the market but being a environmental conscious brand, we recommend using acrylics, the paint that is water base and done least harm to the environment. This is an complex kit and will provide hours and hours of enjoyment. How ever, this kit is meant for anyone age 14 and over, it contain many small and sharp parts so keep it out of reach of small children.

	BE CAREFUL		REMOVE		CEMENT TOGETHER
	PLEASE WAIT FOR A FEW MINUTES UNTIL DAY		MAKE 2pcs		OPEN HOLE
	DO NOT CEMENT		INSTANT GLUE FOR METAL		BEND
	FILL HOLE		APPLY DECAL		OPTIONAL

Parts in box

A

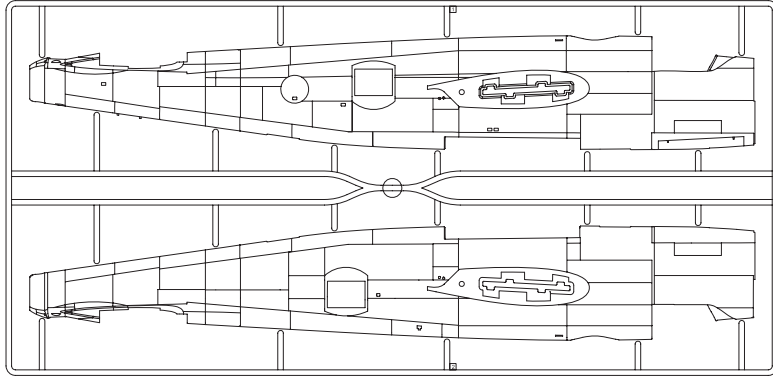

D

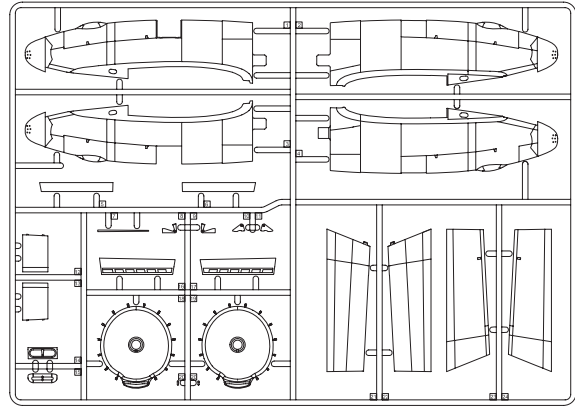

B

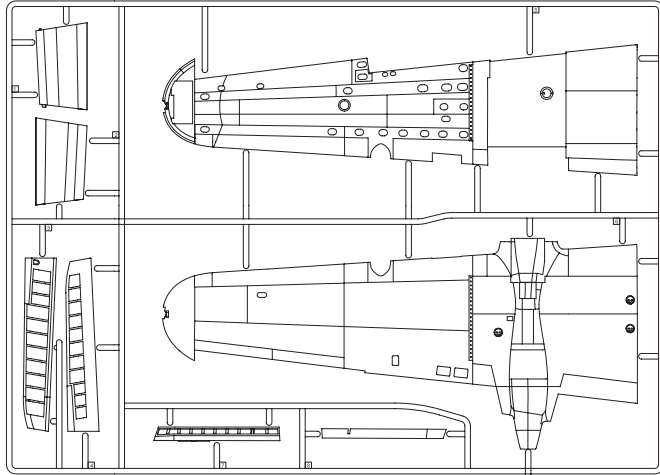

C

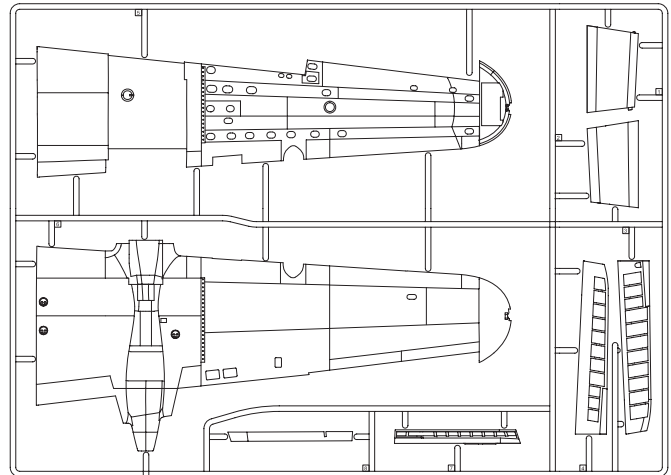

E

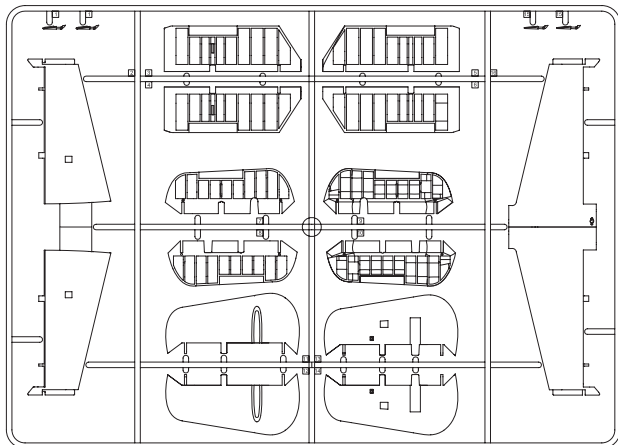

M

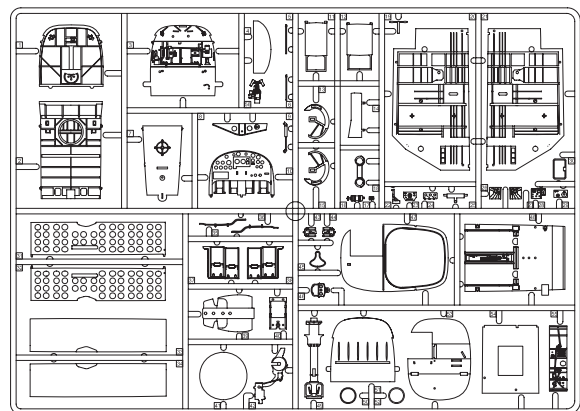

F

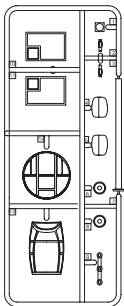

G

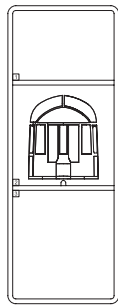

I

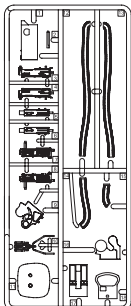

J

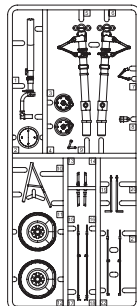

K

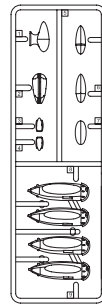

Ox4

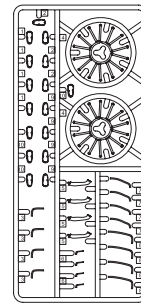

T

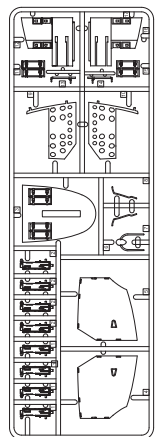

Nx2

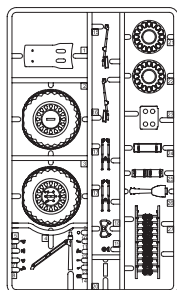

Qx2

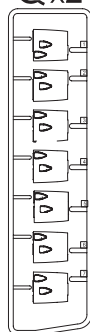

Px3

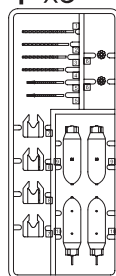

Rx2

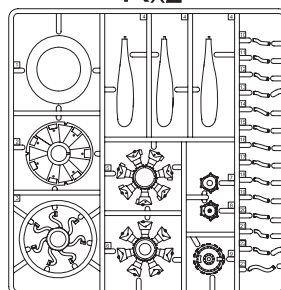

Sx2

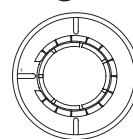

L

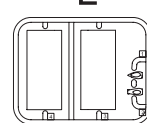

EP

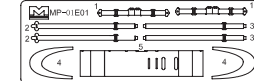

U

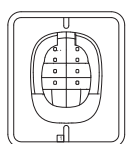

Colour Guide

	Colour	FS 595C	Hobby Color	Tamiya Acrylics
①	Olive Drab	FS34088	H304	XF62
②	Neutral Grey	FS36173	H335	XF53
③	Interior Green	FS34151	H58	XF58
④	Flat White		H11	XF2
⑤	Aluminium		H8	XF16
⑥	Tire Black	FS27038	H77	XF18
⑦	Flat Black	FS37038	H12	XF1
⑧	Brown		H310	XF10
⑨	Clear Red		H90	XF27
⑩	Clear Green		H94	XF25
⑪	Clear Orange		H92	XF26
⑫	Gun Metal		H18	X10
⑬	Rust		H344	XF52

1 Upper gun turret column assembly

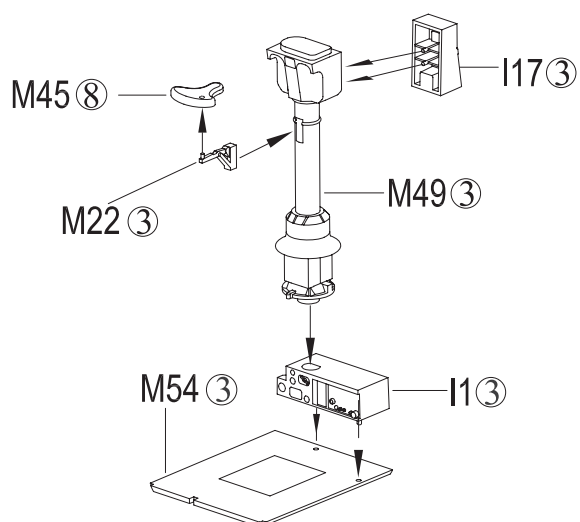

2 Tail gun assembly

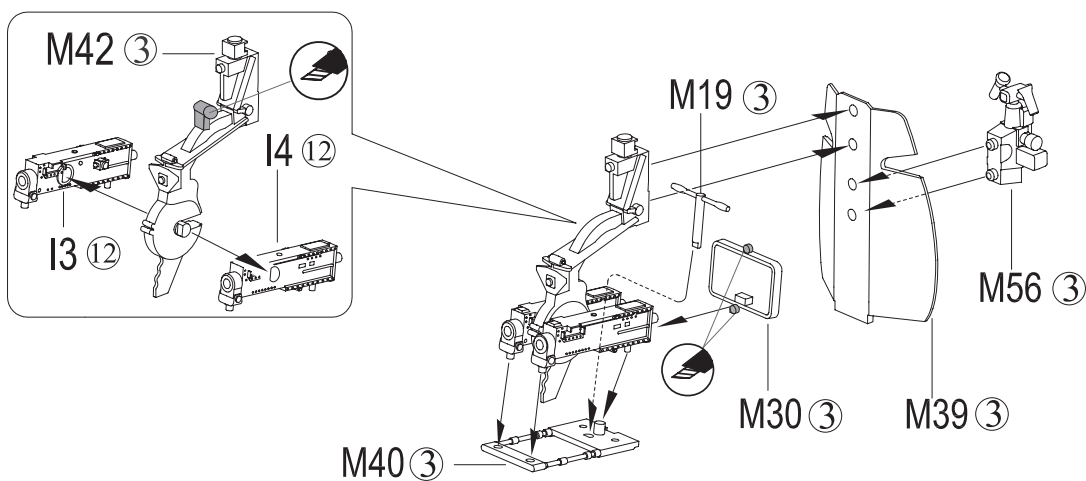

3 Central pedestal assembly

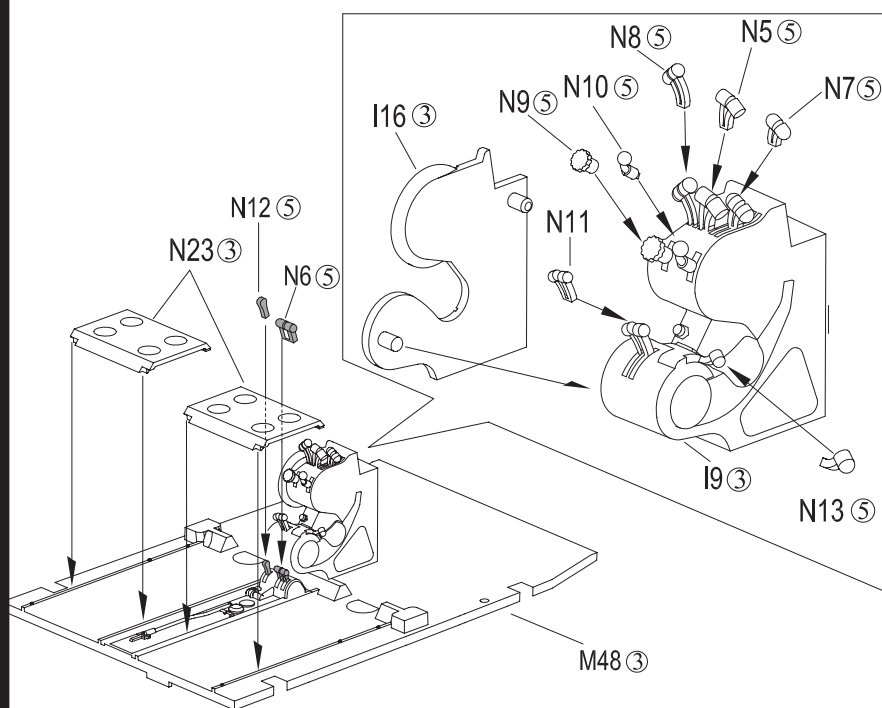

4 Seats and control columns assembly

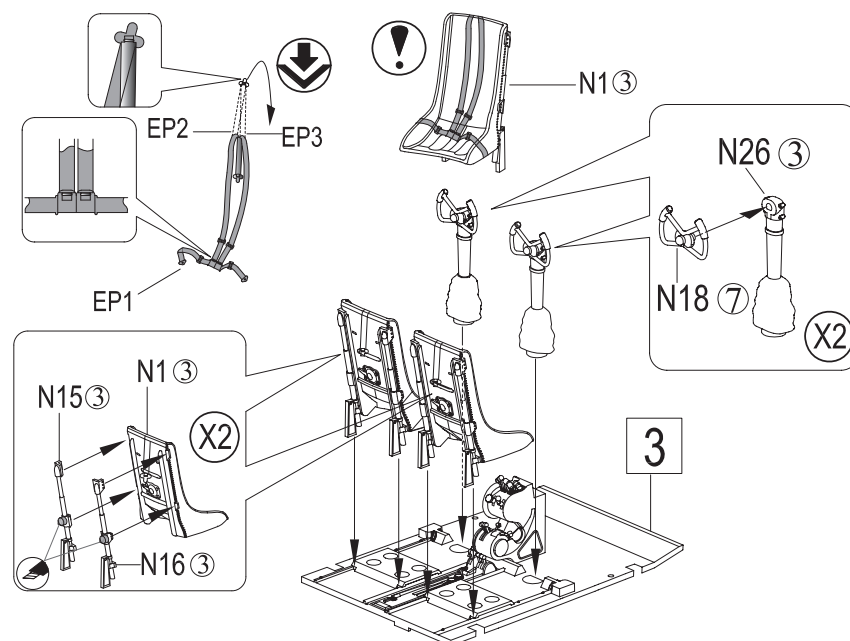

5

Bombs and bomb bay assembly

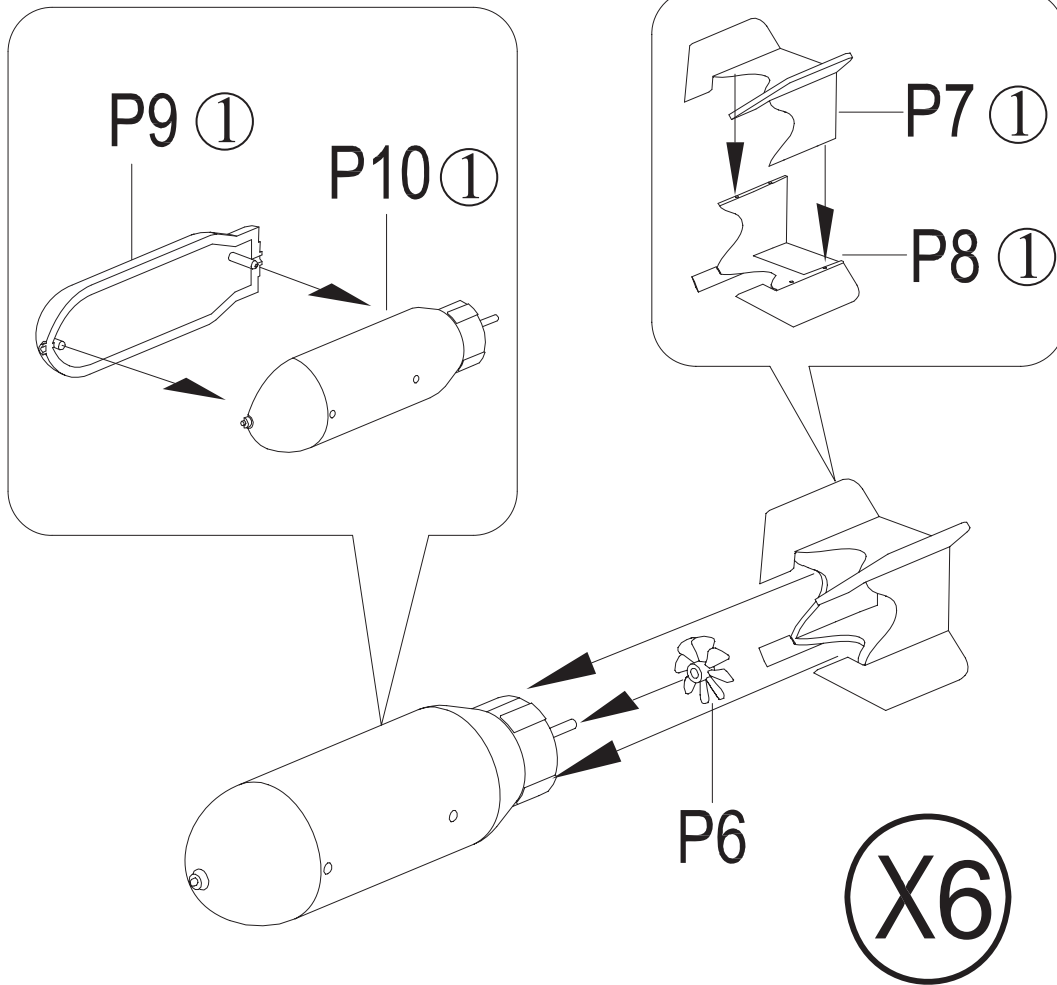

6

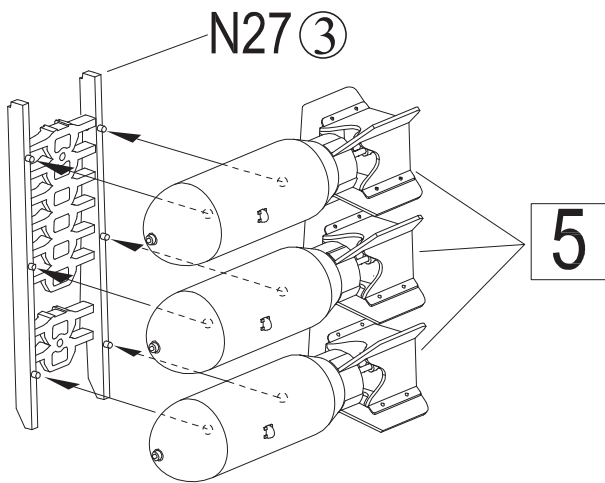

7

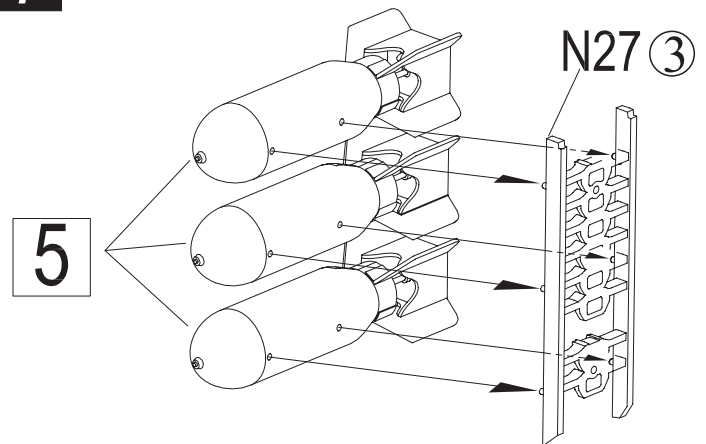

8

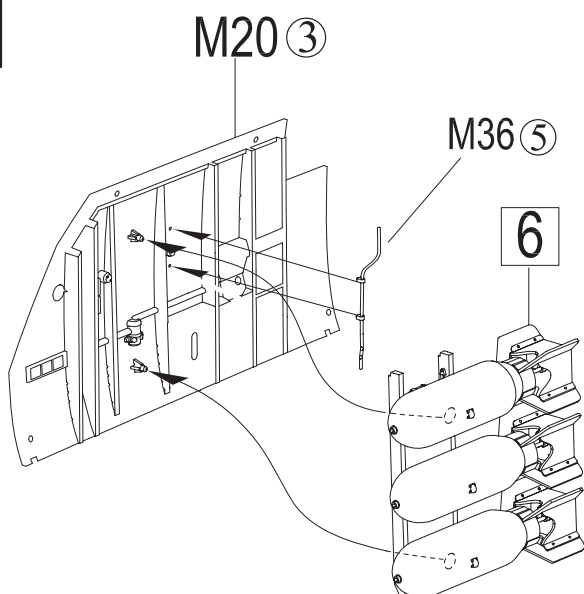

9

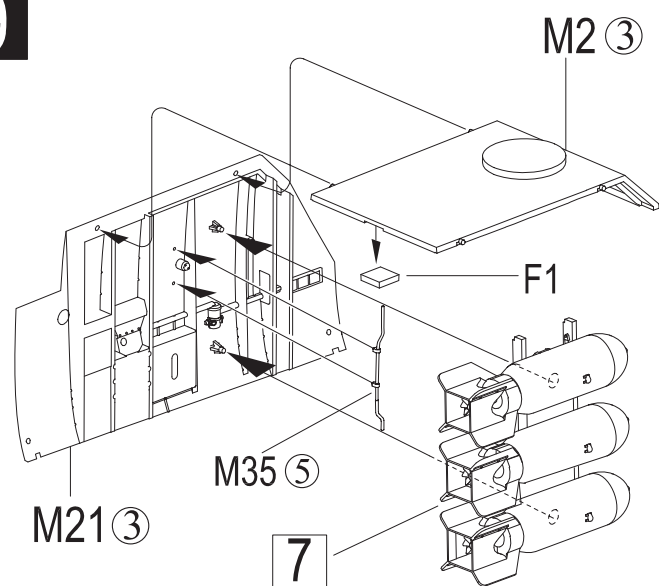

10

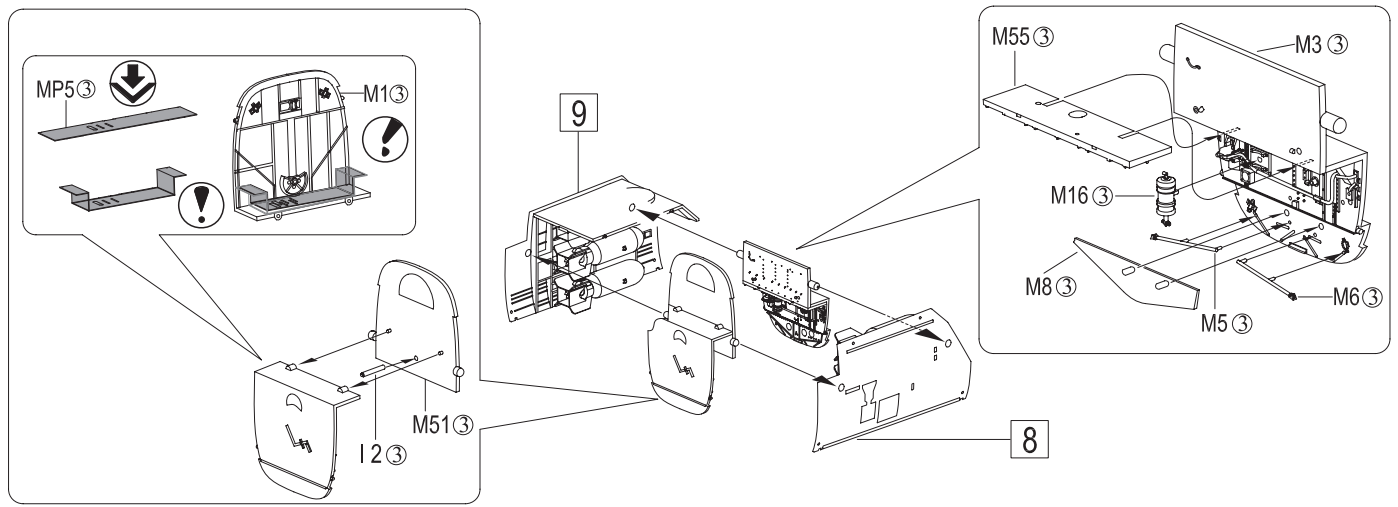

11

Right fuselage half interior assembly

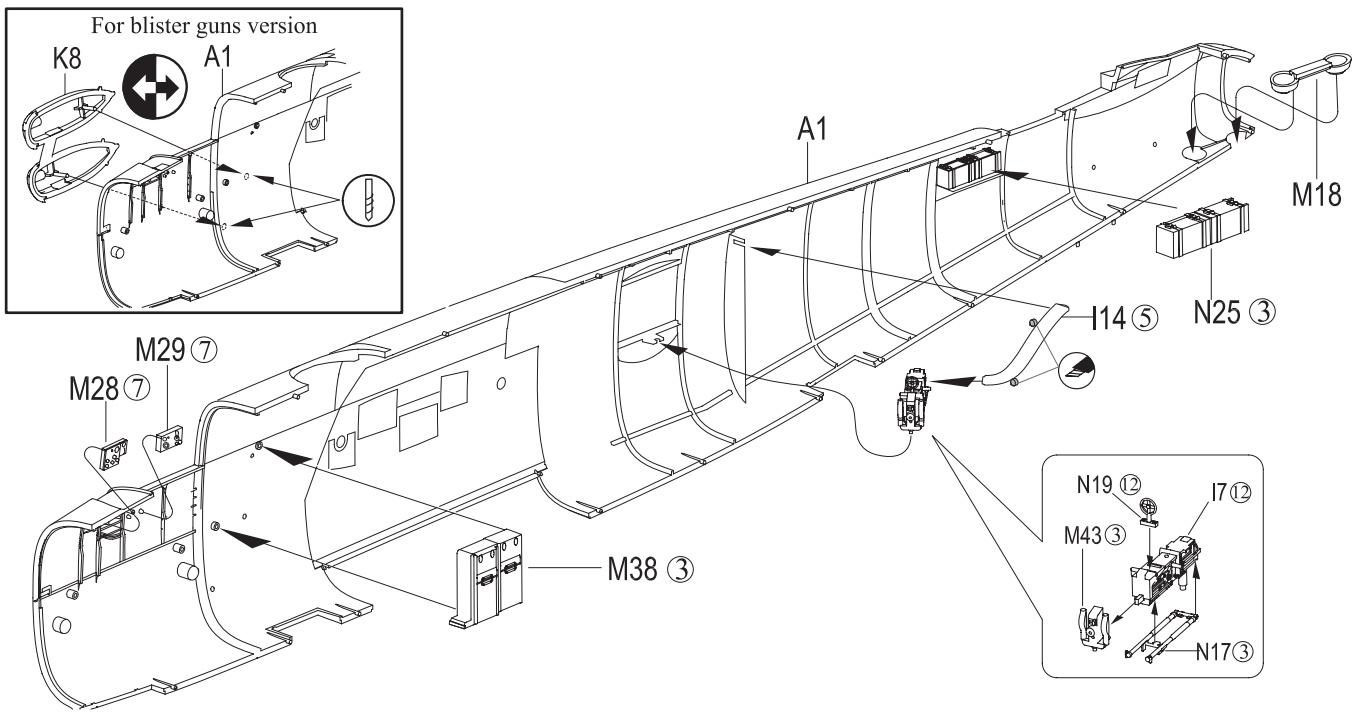

12

Left half fuselage interior assembly

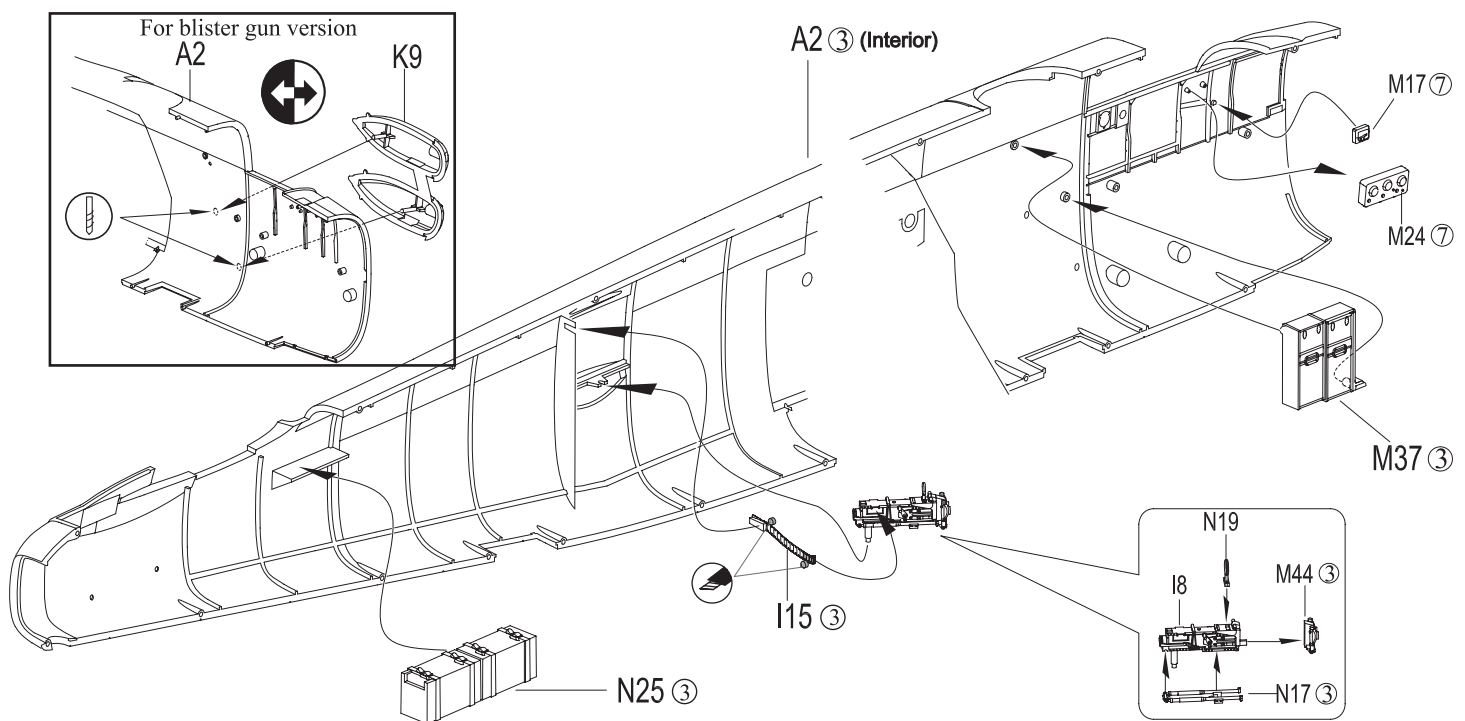

13 Fuselage main components assembly

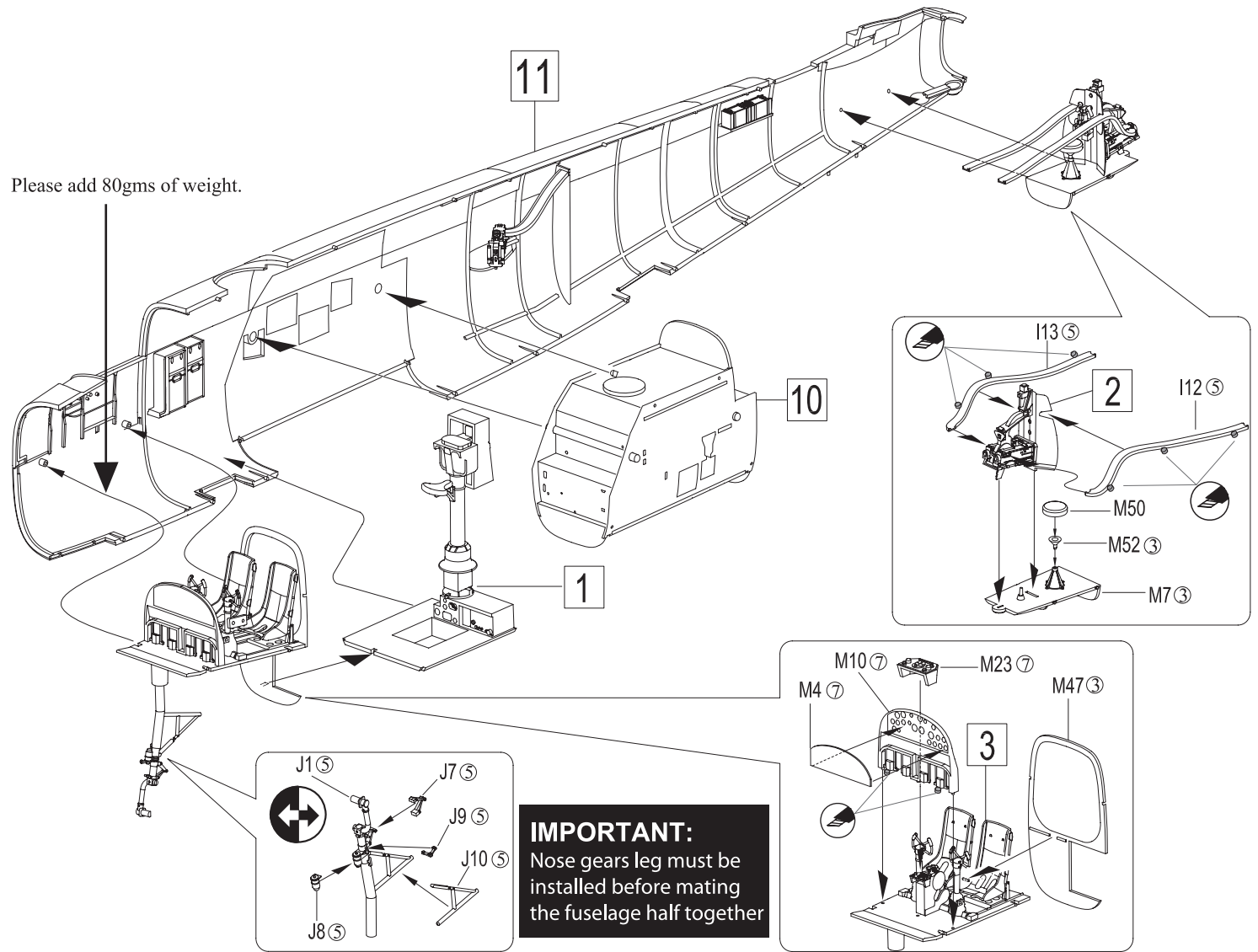

14 Mating the two fuselage half and installing of the waist gun windows

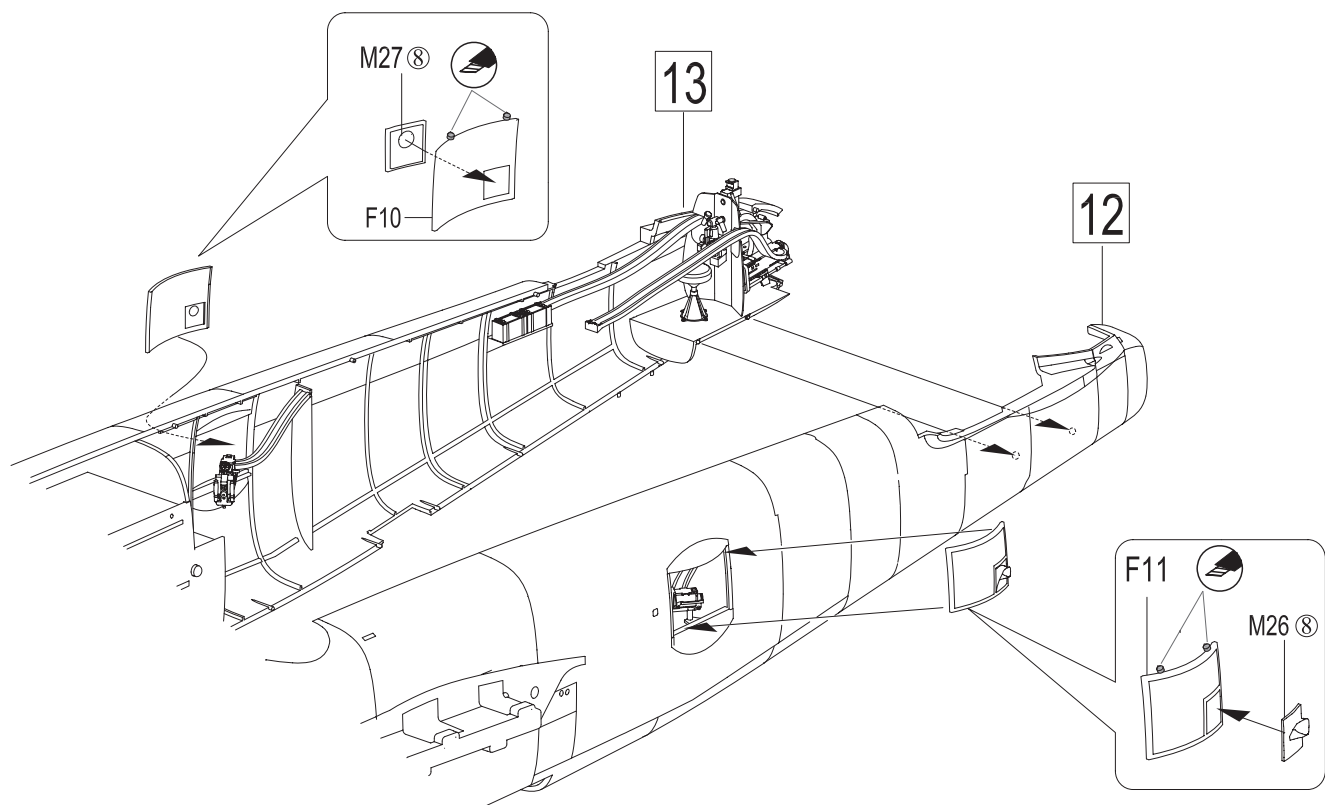

15 Tail section assembly

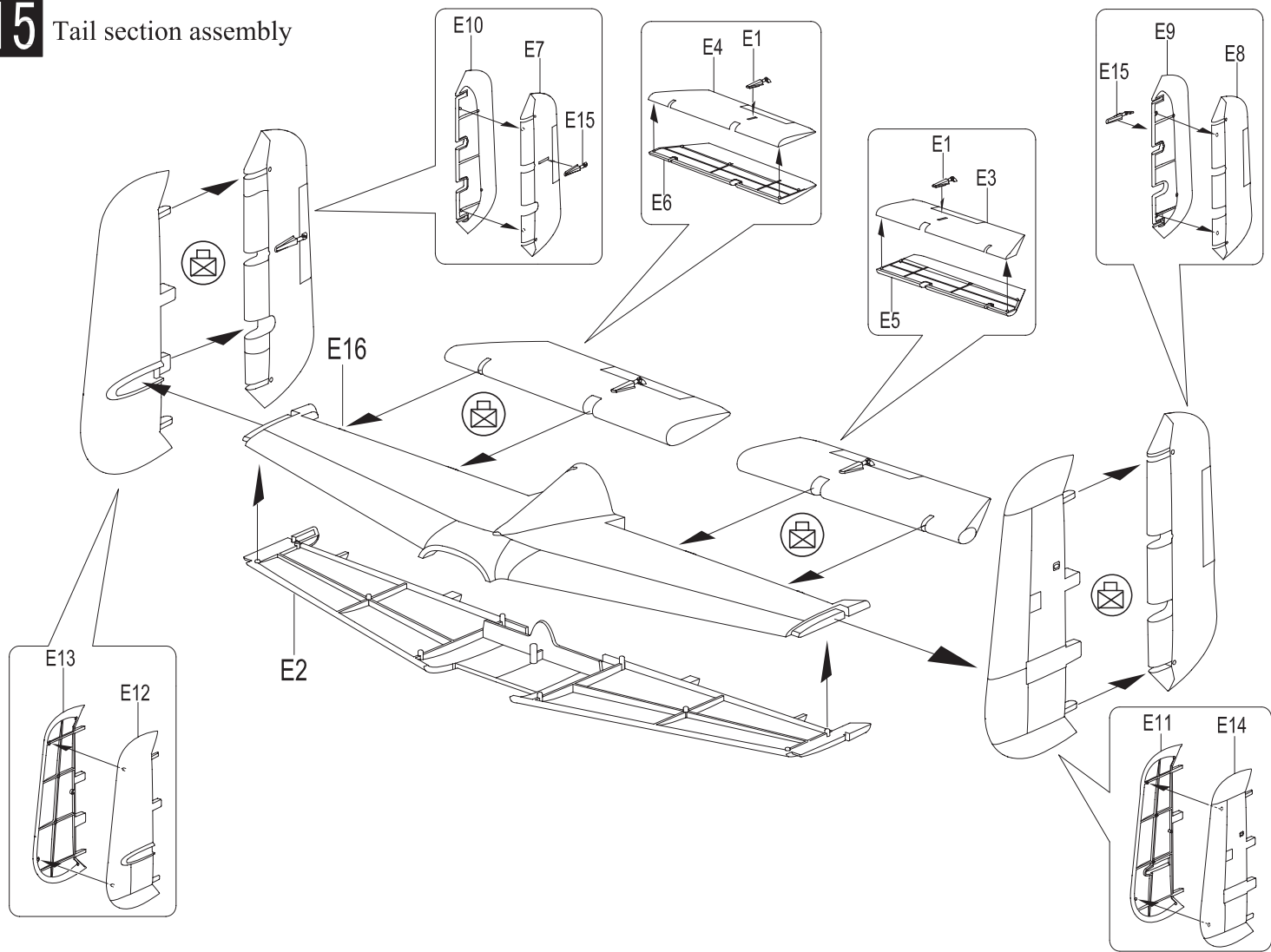

16 Fuselage exterior assembly

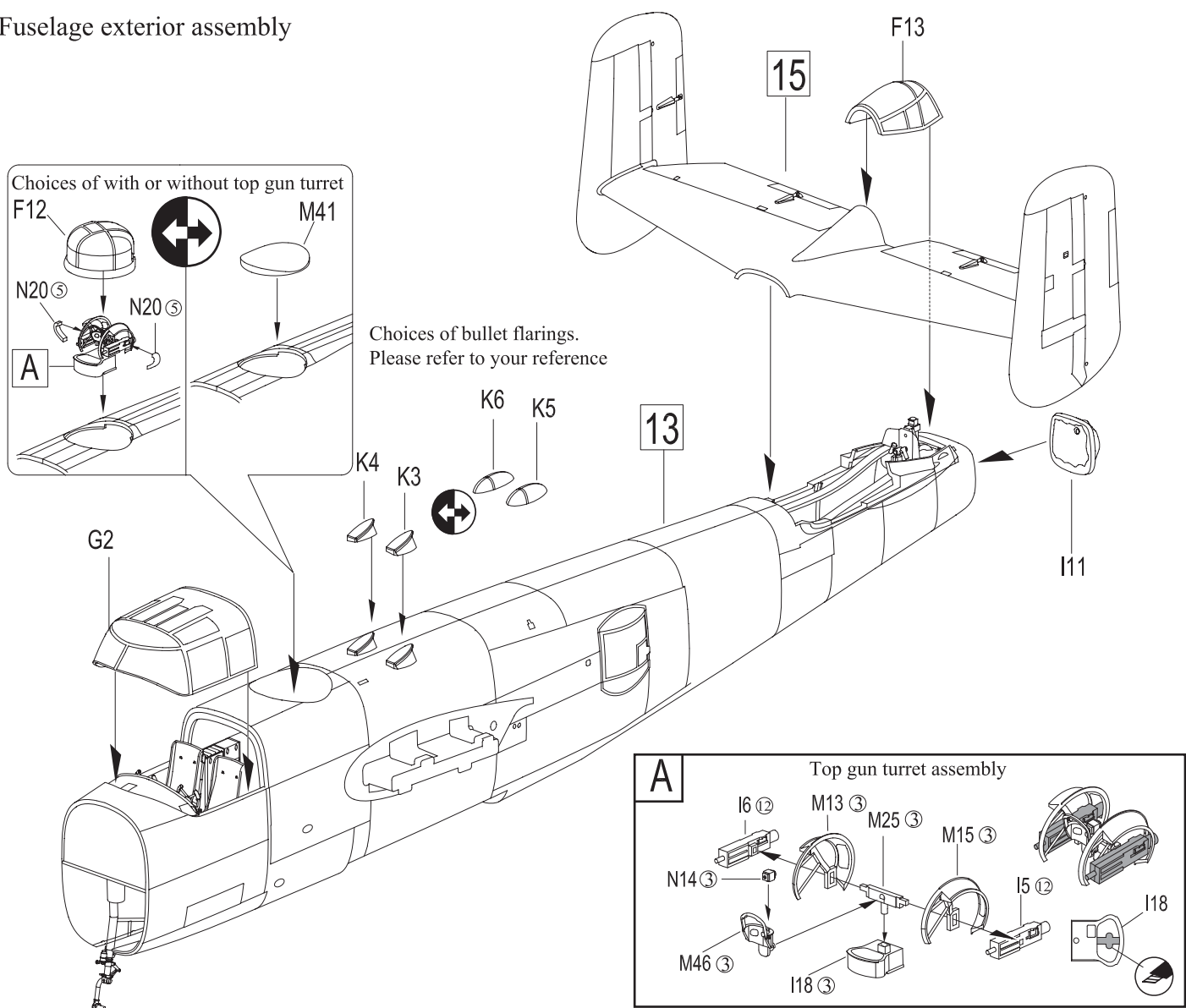

17

Fuselage bottom components assembly with bomb bay doors and entrances open

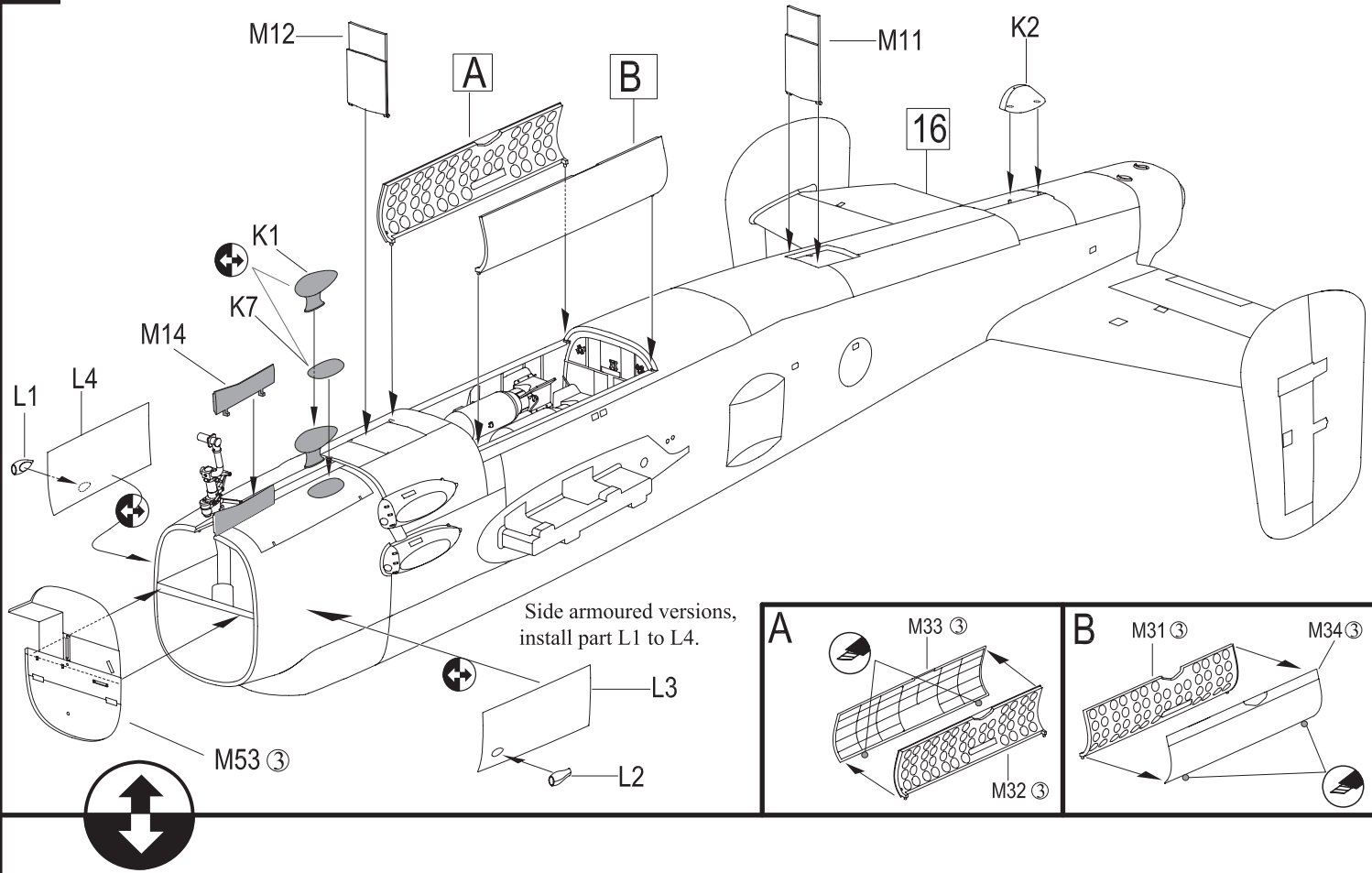

Fuselage bottom components assembly in flight version

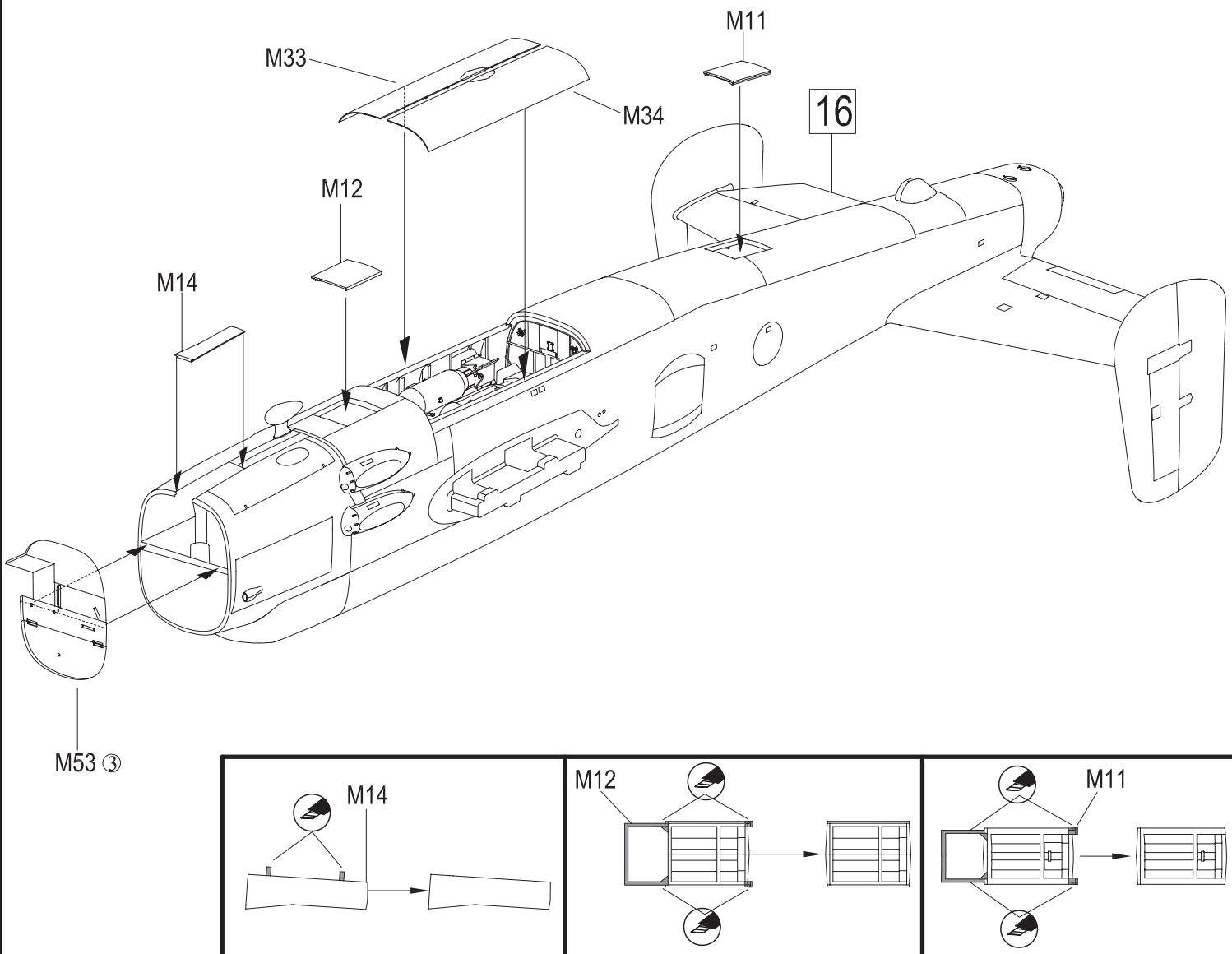

18 Left wing and control surfaces assembly

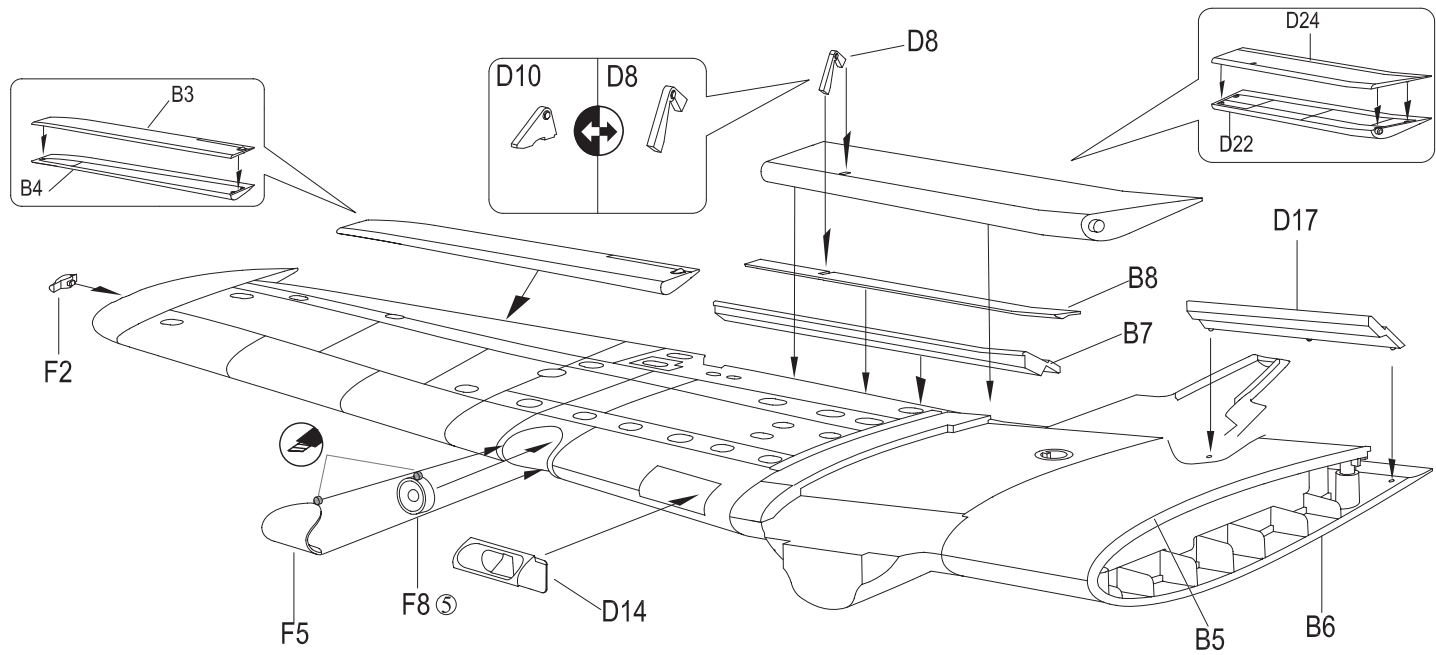

19 Engine assembly (Make two)

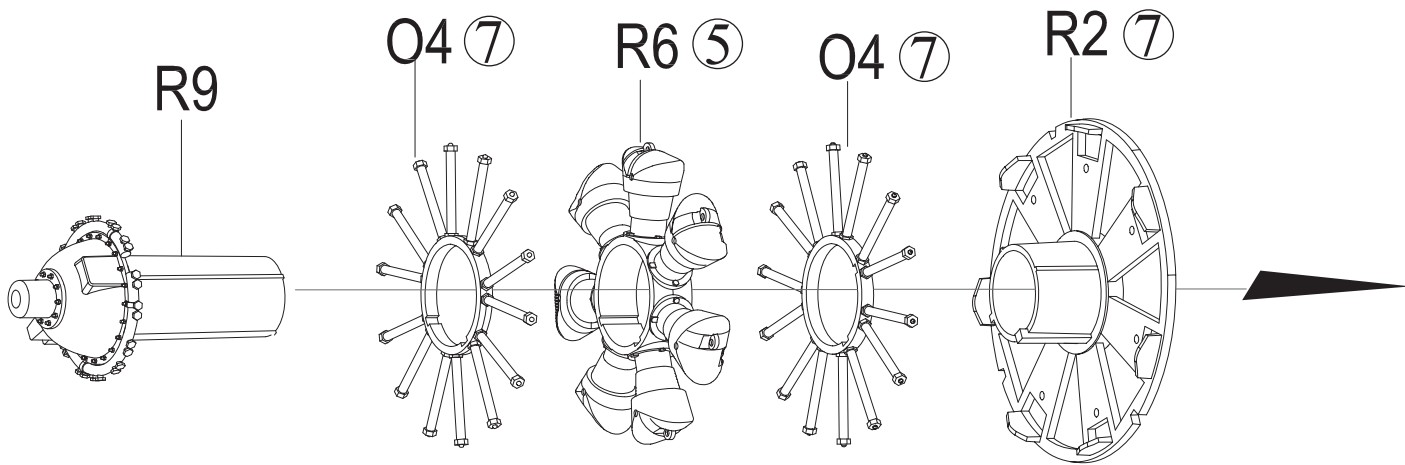

20

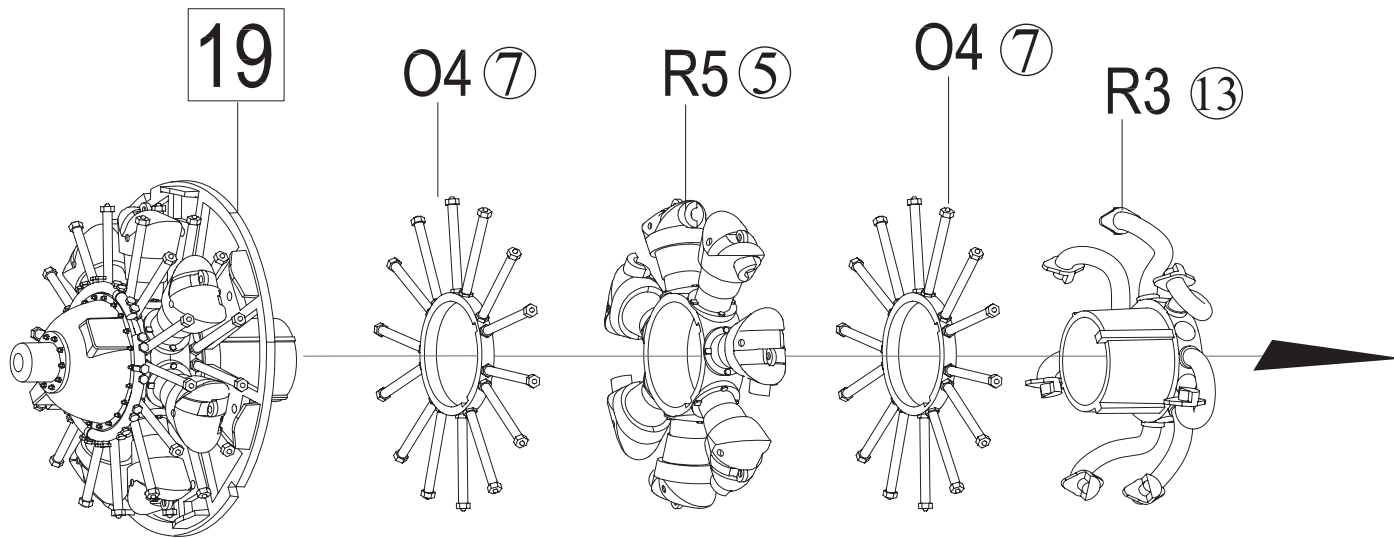

21

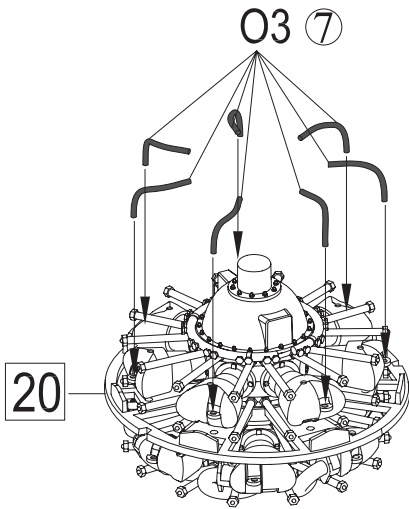

Please note the positions of part O3

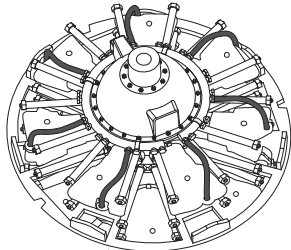

Top roll of cylinders

22

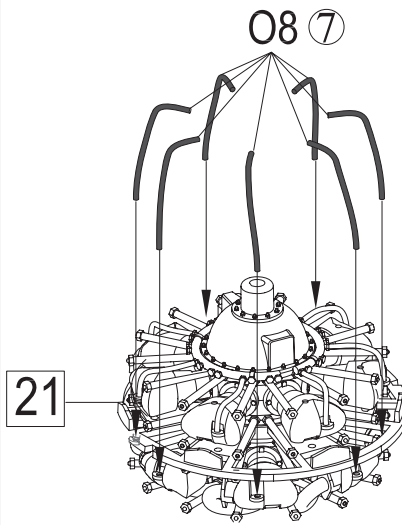

Please note the positions of part O8

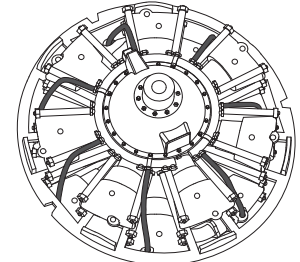

Back roll of cylinders

23

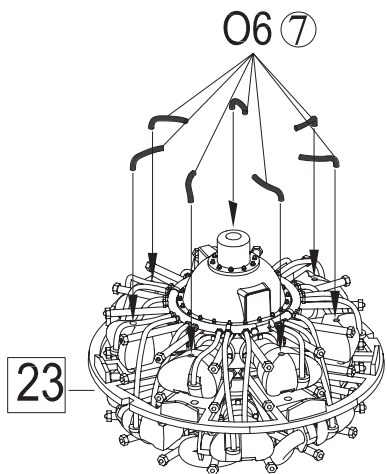

Please note the positions of part O6

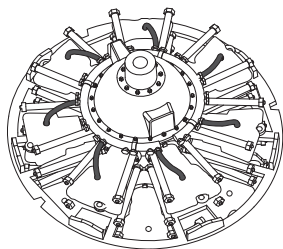

Front roll of cylinders

24

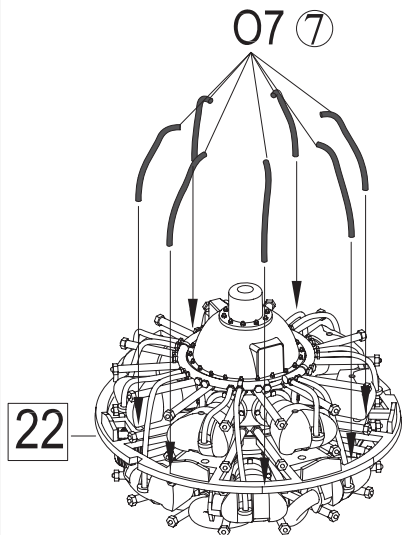

Please note the positions of part O7

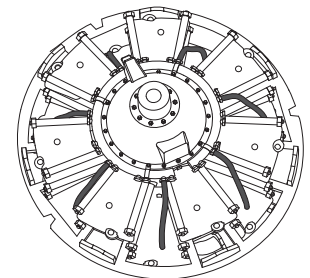

Top roll of cylinders

25 Engine's back

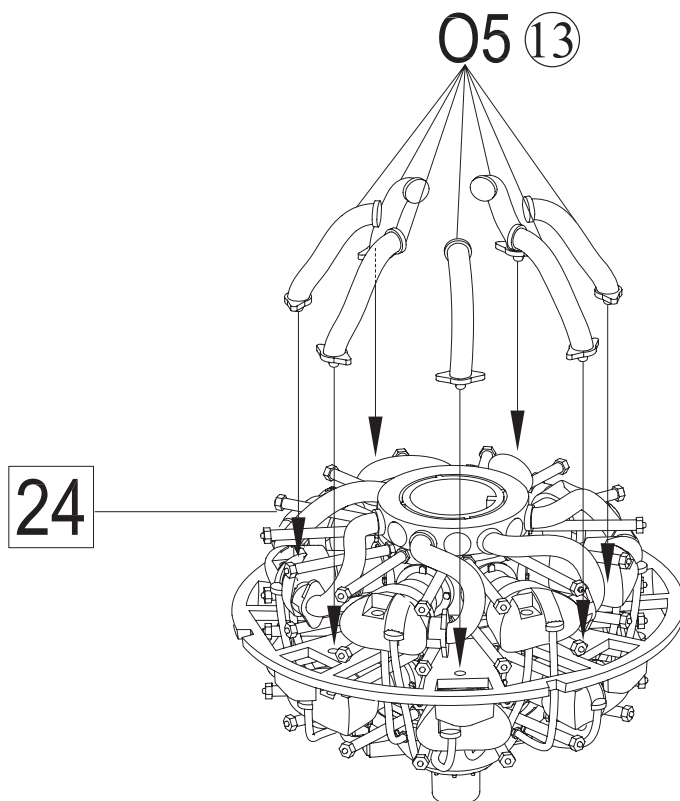

26 Push rod covers assembly (Back)

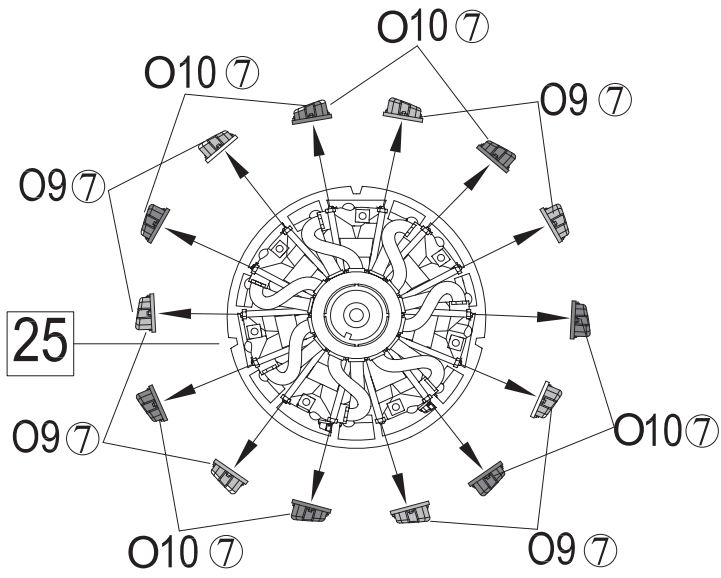

27 Push rod covers assembly (Front)

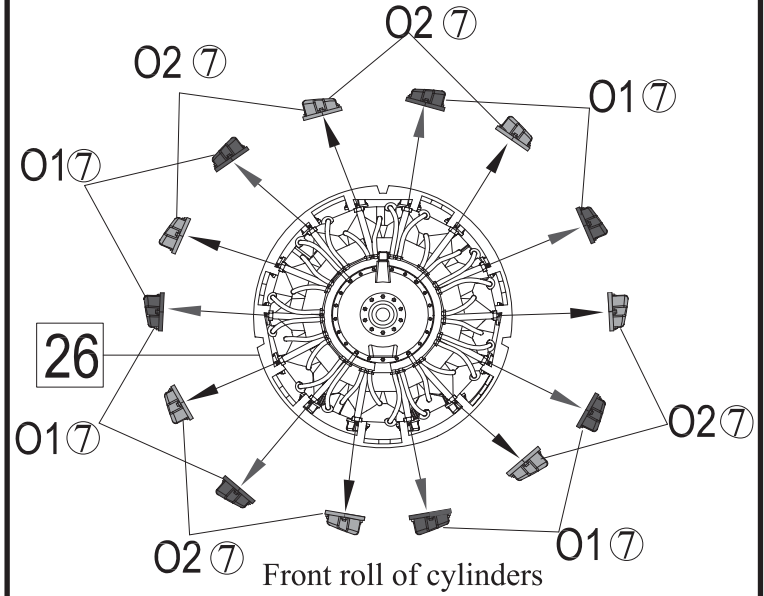

28 Please note the direction of push rod covers

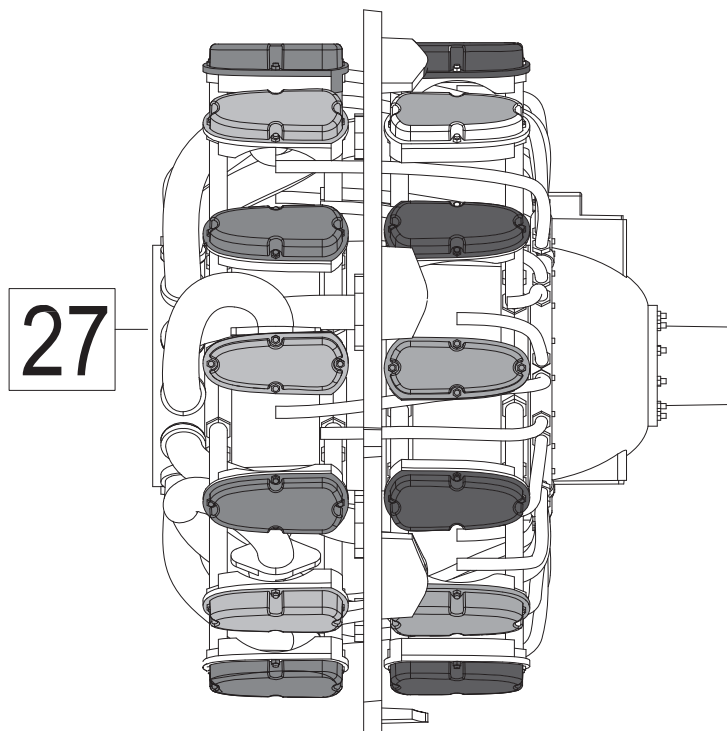

29 Assembling of engine frame

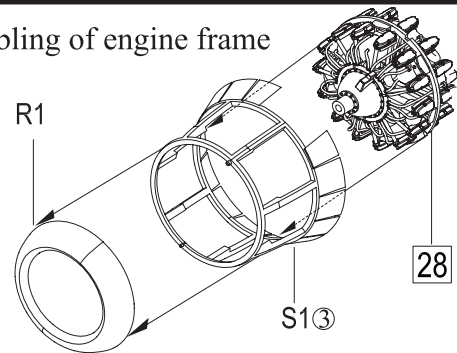

30 Assembling of exhaust stacks

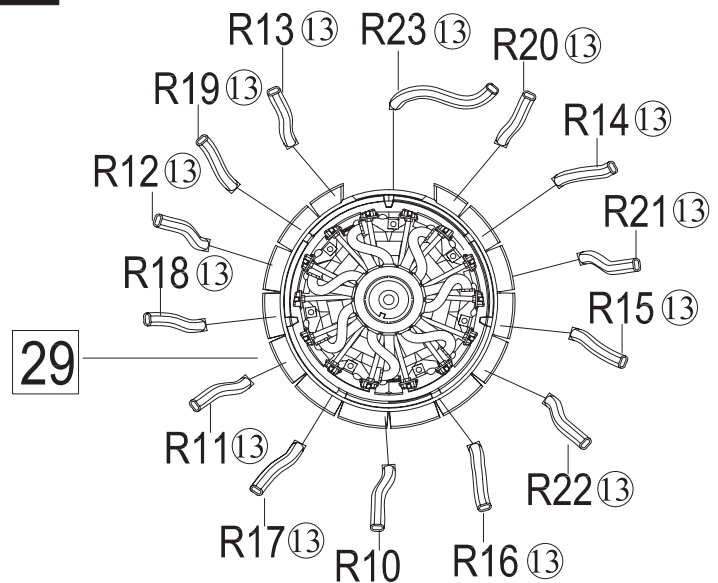

31 Engine nacelle covers assembly

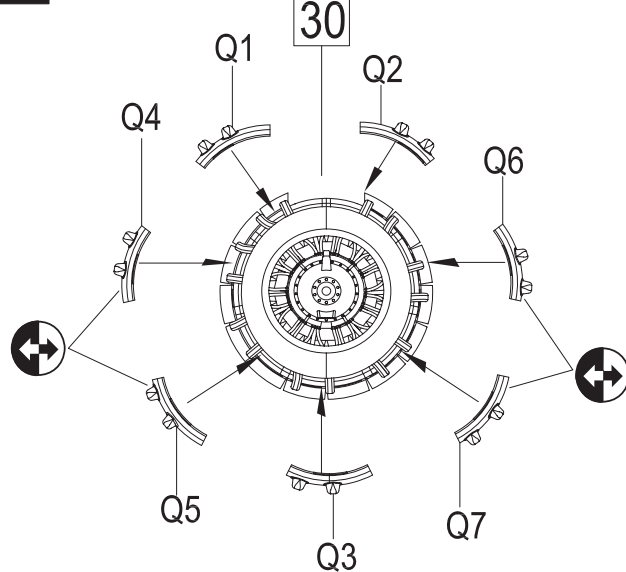

32 Propeller assembly (Make 2)

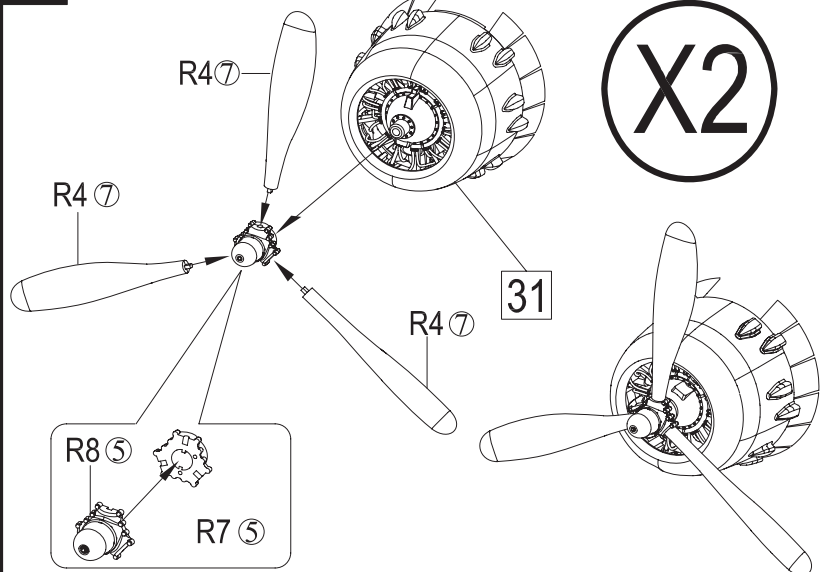

33 Assembling of engine nacell and landing gear in gear down position of left wing

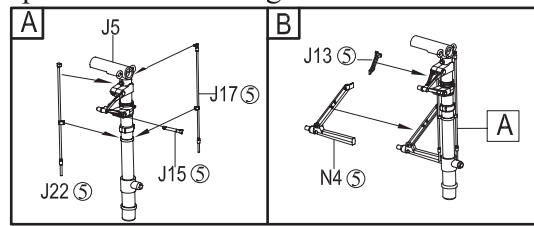
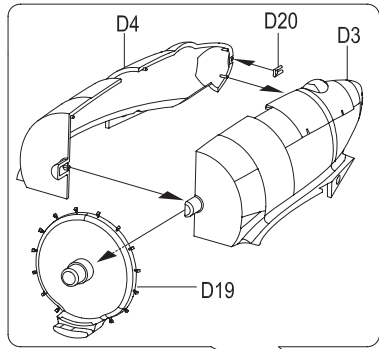

Procedures of installing the engine nacell

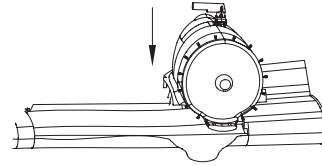

1. Pass the main gear strut through the opening of the engine nacell.

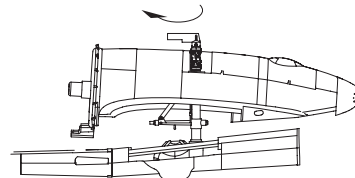

2. Turn the nacell side way so the supporting structure pass through the nacell.

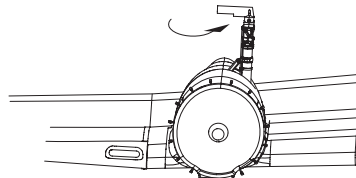

3. Turn the nacell back to the right direction and install on to the wing.

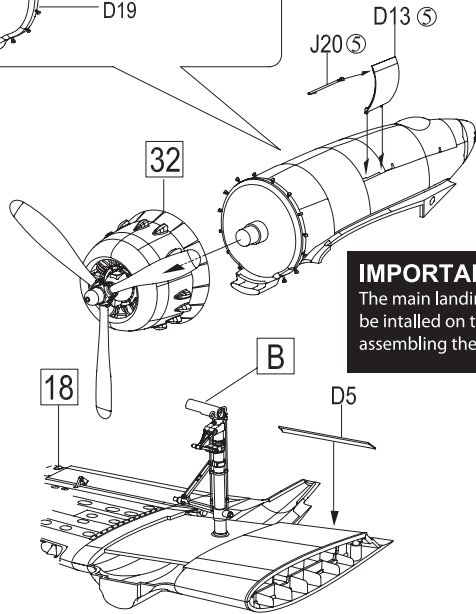

IMPORTANT:
The main landing gear strut must be installed on to the wing before assembling the engine nacell.



Assembling of engine nacell with gear up position of left wing

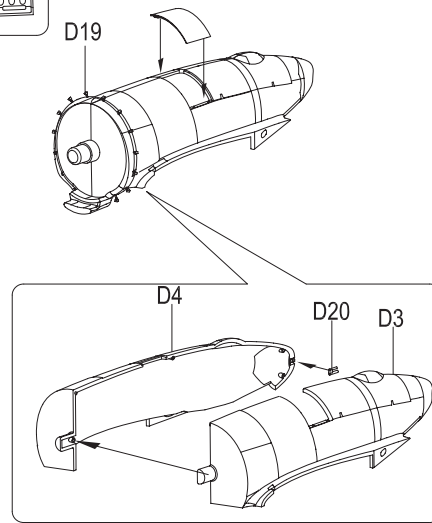
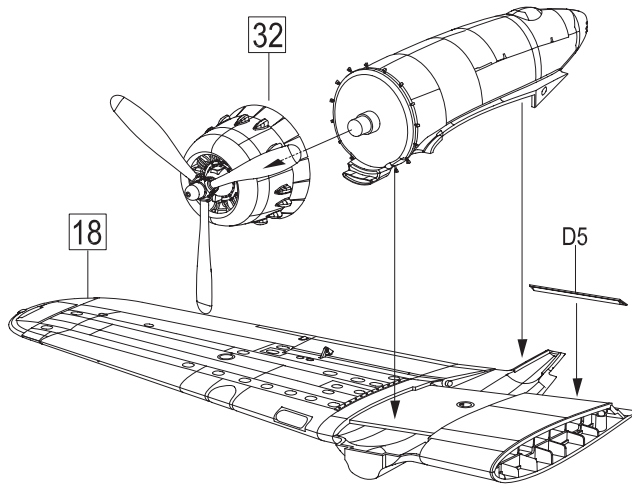
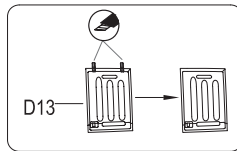

34 Assembling of right wing and control surfaces

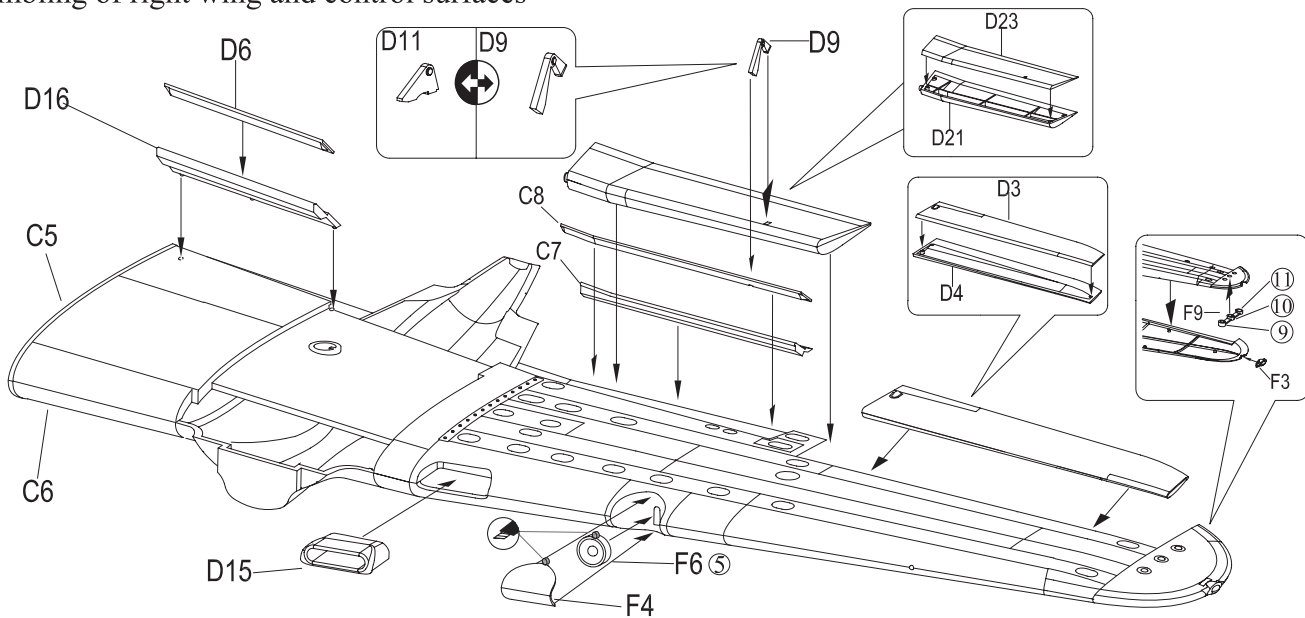

35 Right wing with landing gear in gear down assembly

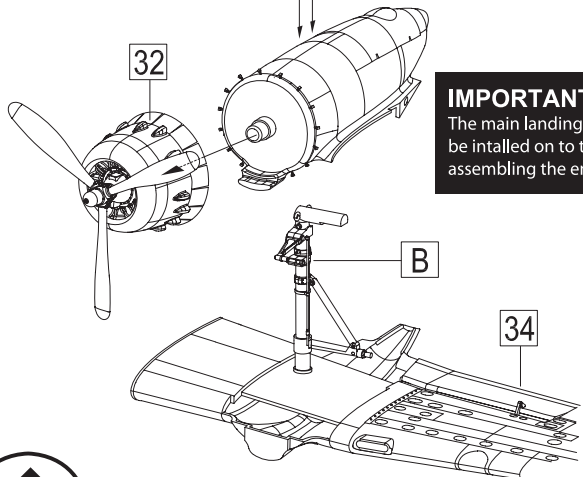
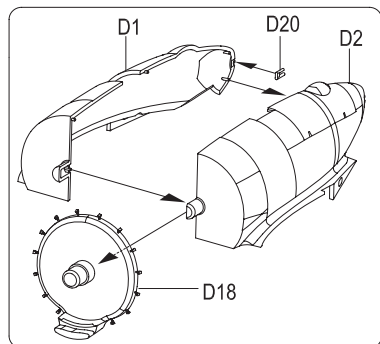

IMPORTANT:
The main landing gear strut must be installed on to the wing before assembling the engine nacell.

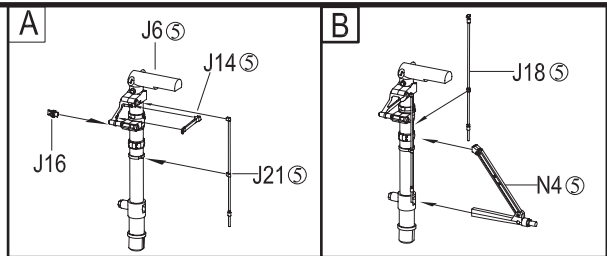

Procedures of installing the engine nacell

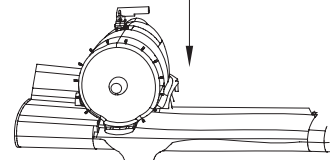

1. Pass the main gear strut through the opening of the engine nacell.

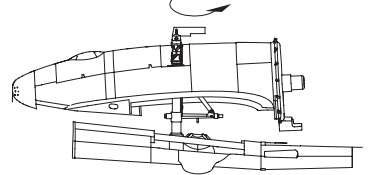

2. Turn the nacell side way so the supporting structure pass through the nacell.

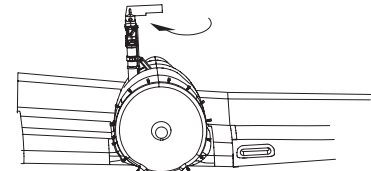

3. Turn the nacell back to the right direction and install on to the wing.



Right wing, engine nacelle with gear up position assembly

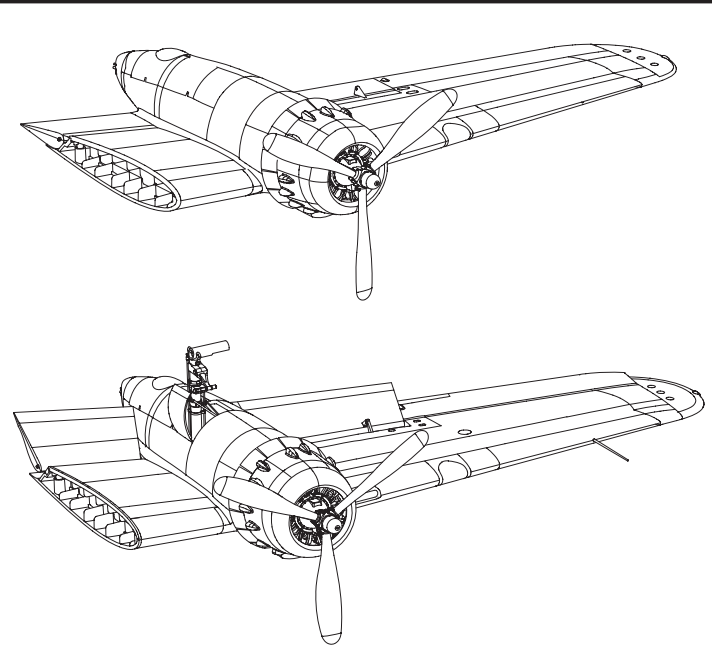
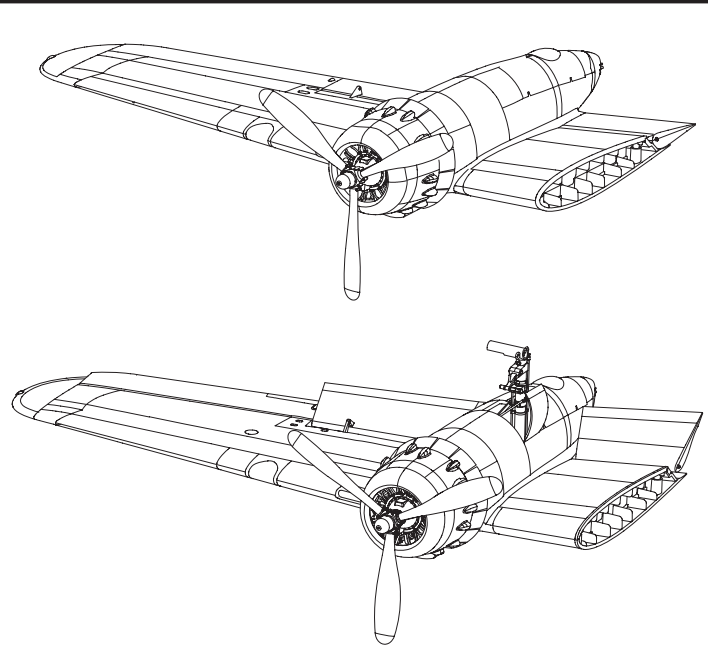
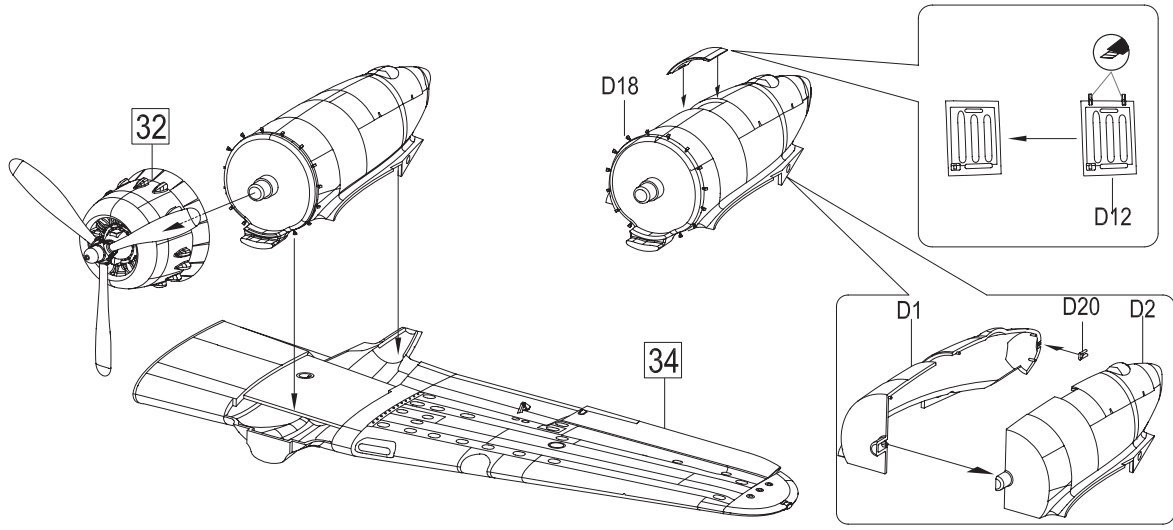

36 Nose assembly of straffer version.

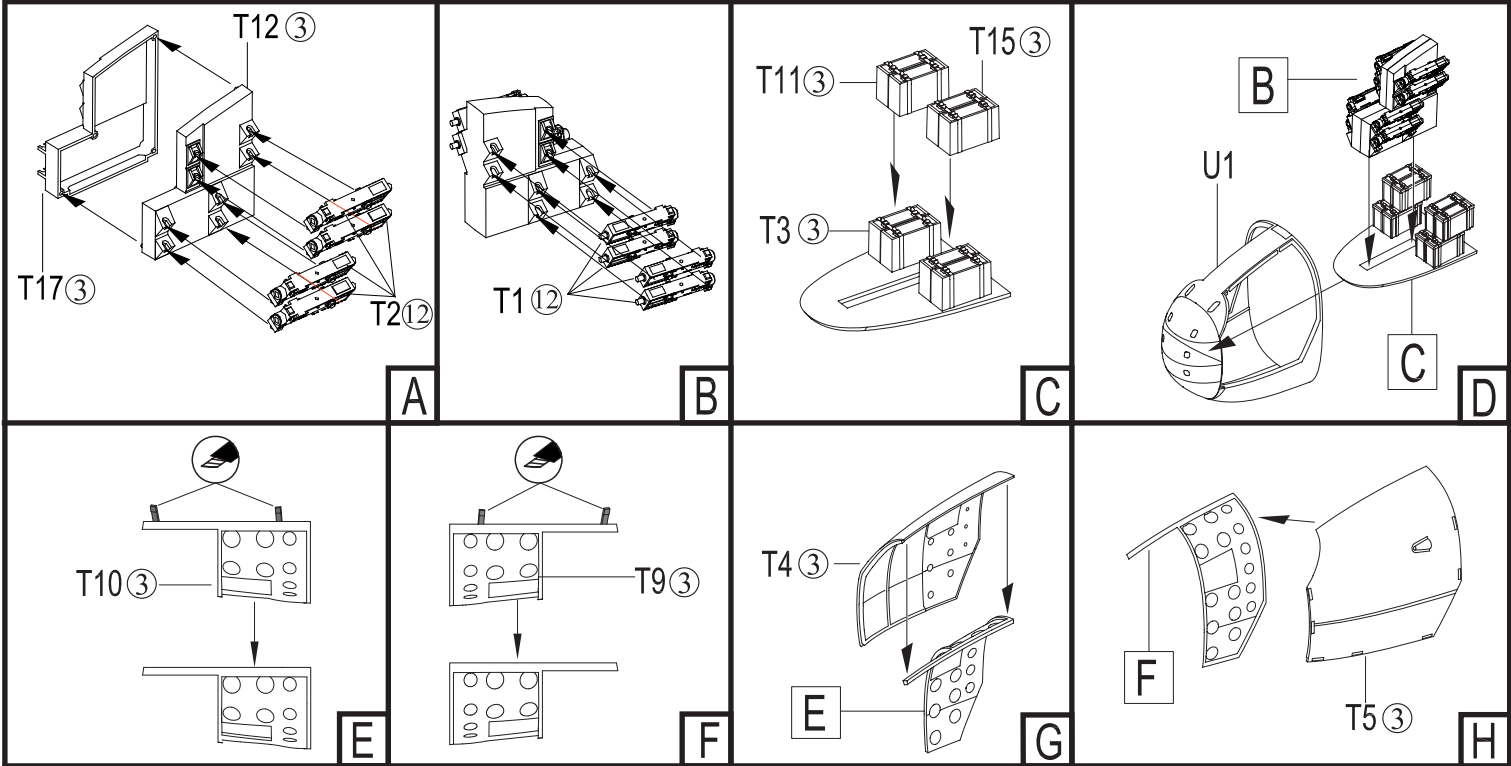

Armunations loading doors closed position.

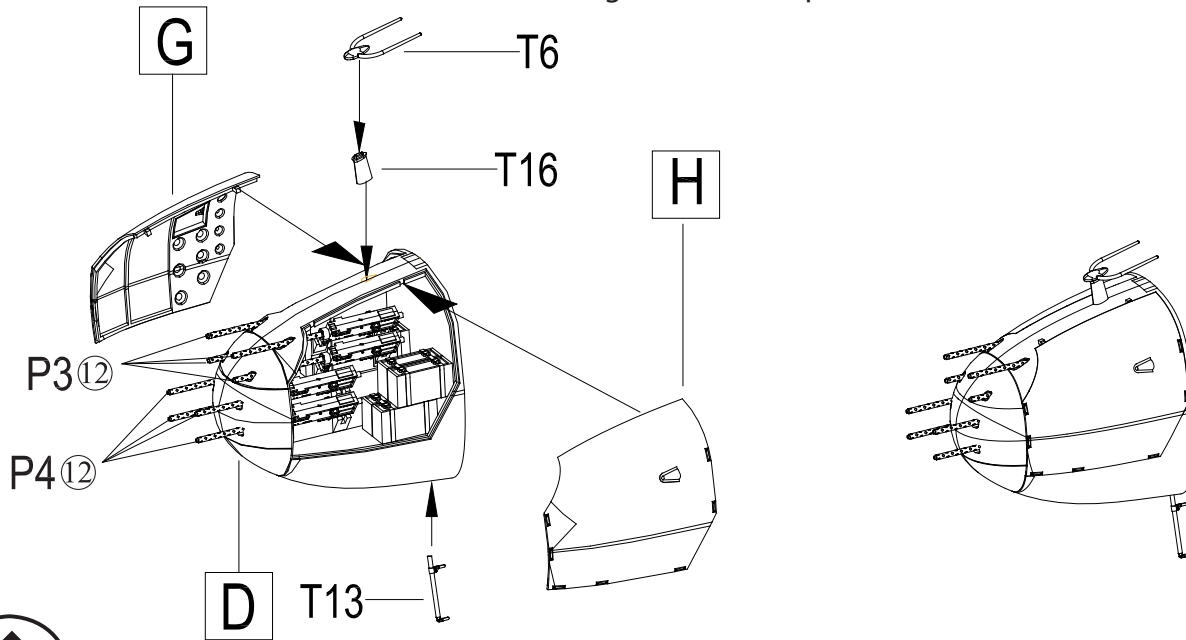

Armunations loading doors open position.

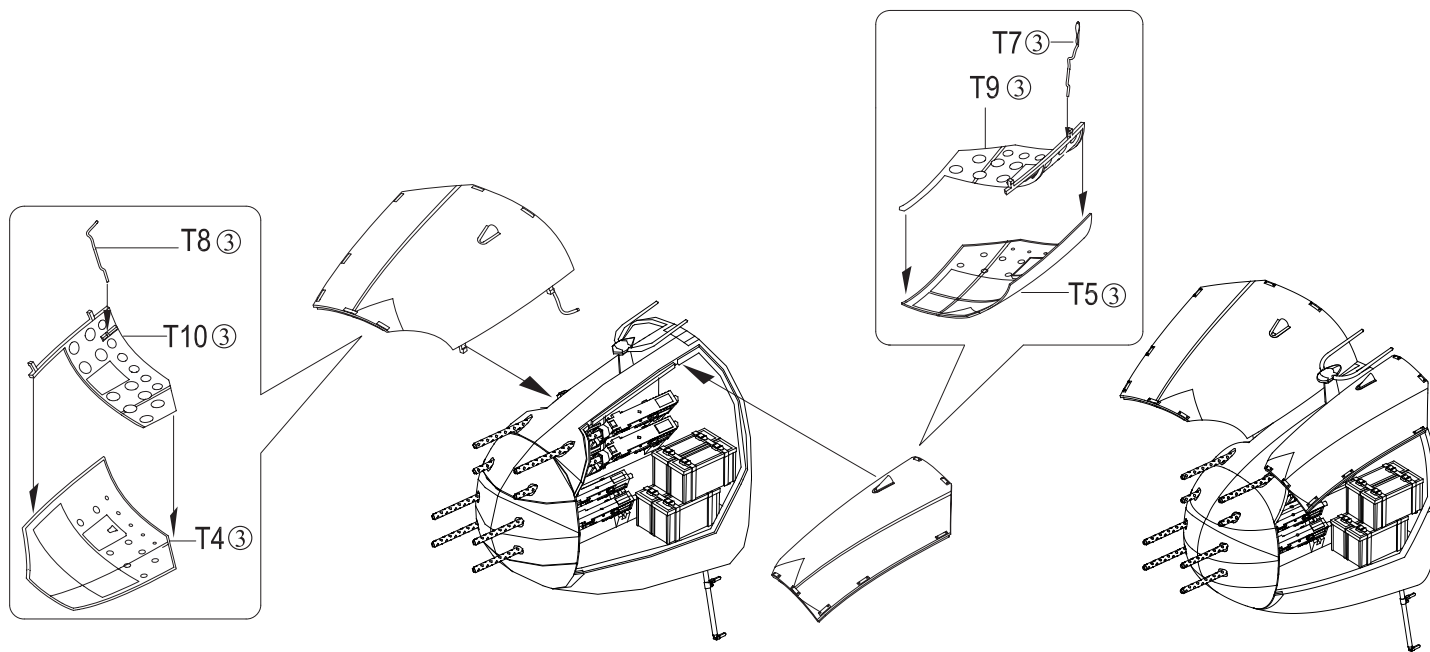

37 Final assembly, gears down position

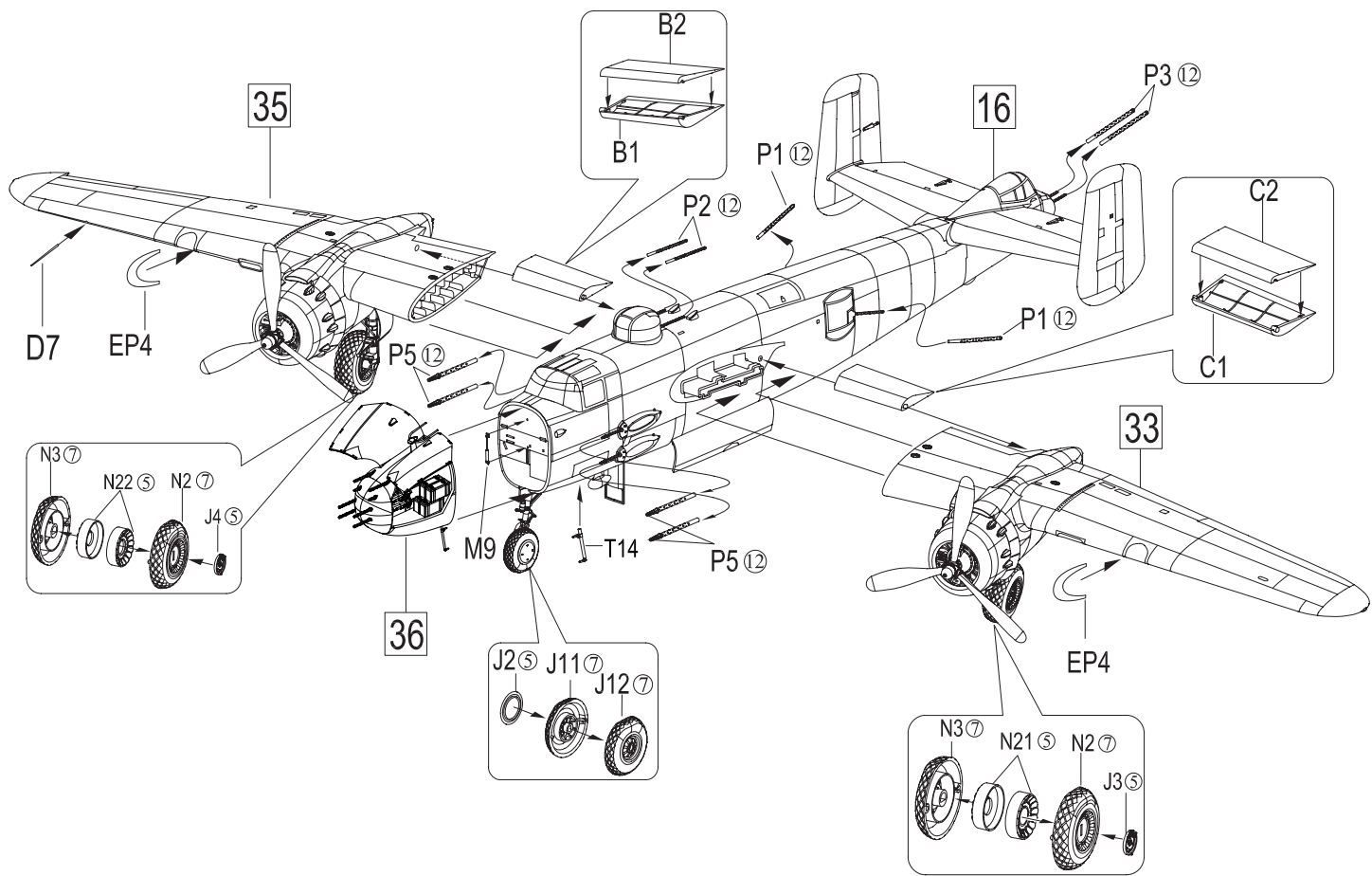

37

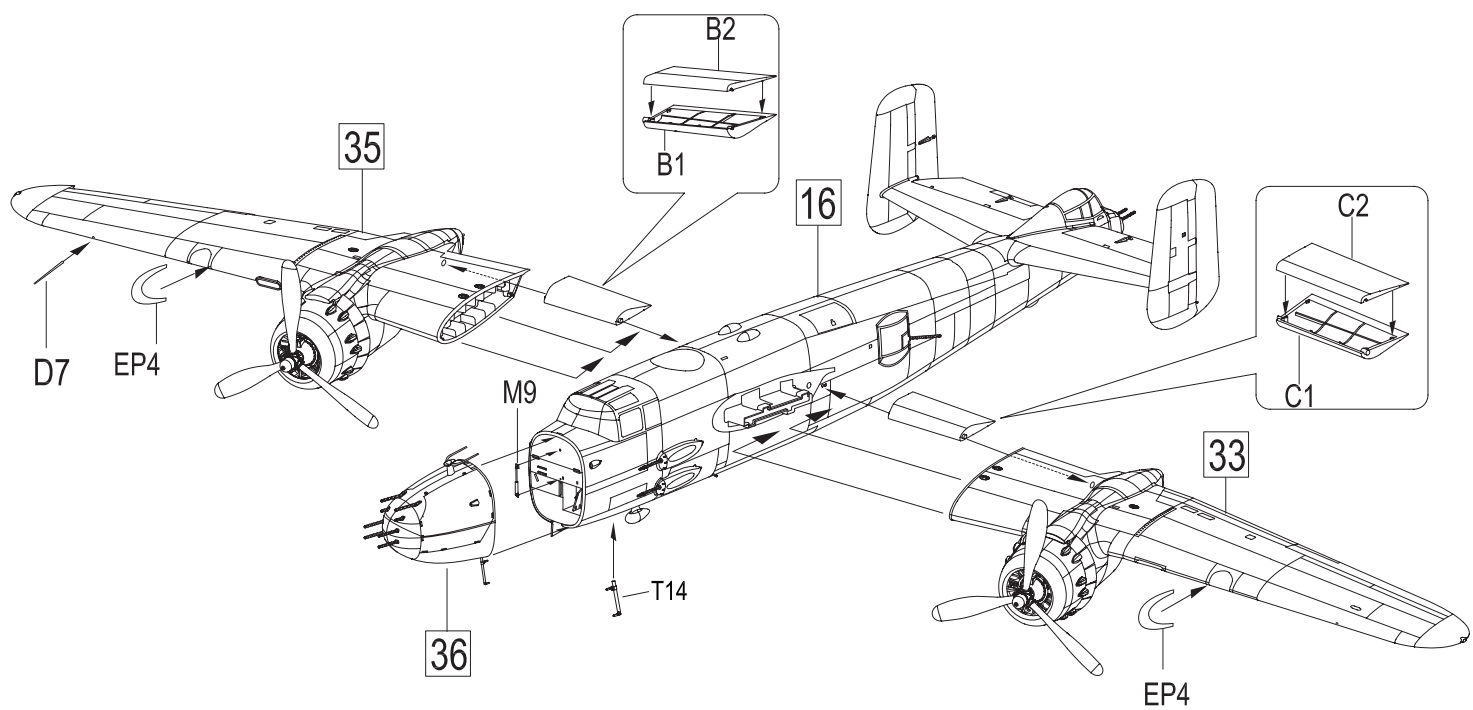

Final assembly, flight position

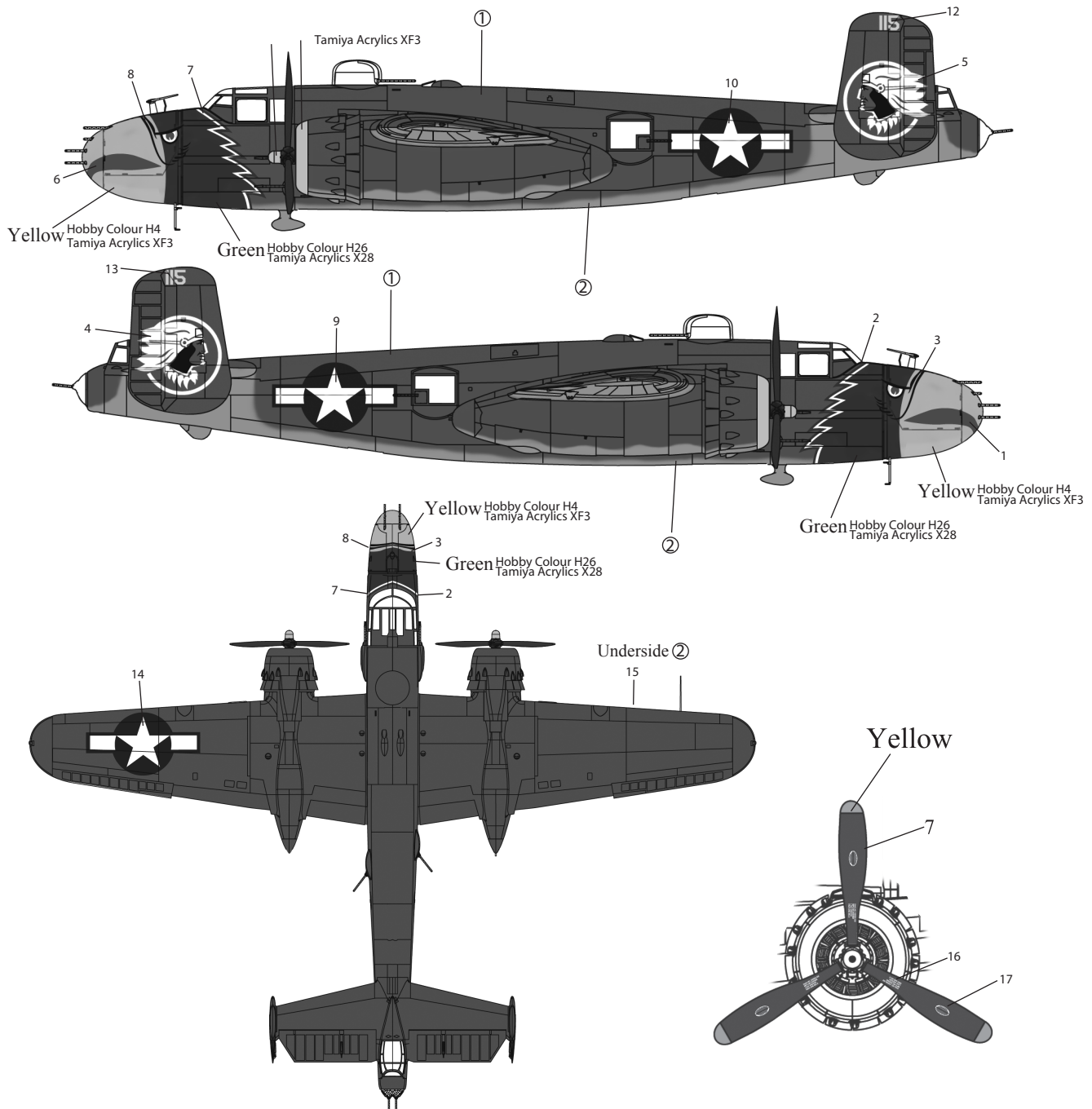
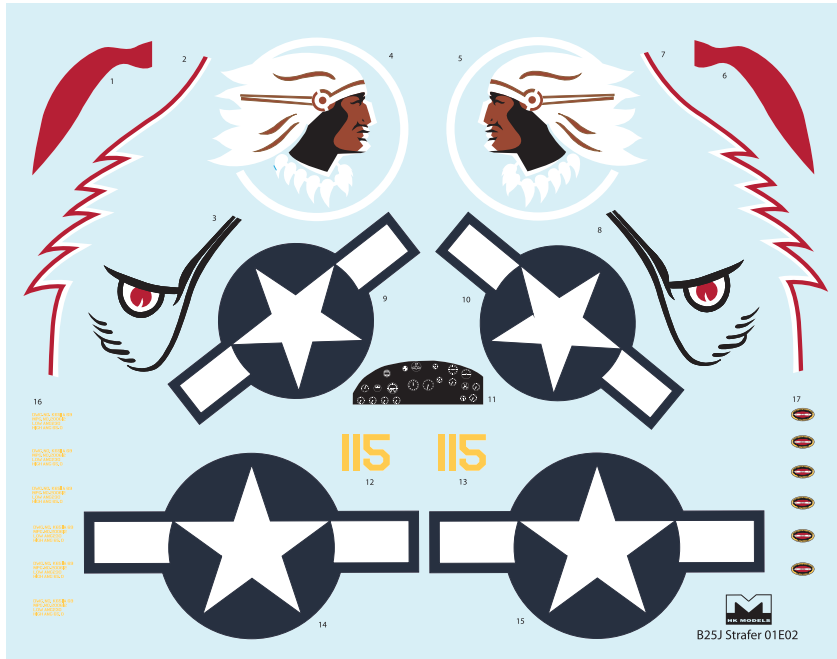

Hong Kong Models Co., Ltd

Address: Flat 12, 12/F., Block A, Tak Lee Industrial Center. Ching Yeung Street. Tuen Mun. N.T. Hong Kong.

Tel: 852-2464 9813 Fax: 852-2626 4864

Website: www.hk-models.com E-mail: info@hk-models.com