

July '06

GT2 FACTORY Team

Instruction Manual for the RC10GT2



This manual covers the following vehicles:

7080: Factory Team GT2 Kit
7092: GT2 RTR Nitro Truck



www.RC10.com • www.TeamAssociated.com

Thank you for purchasing this Team Associated product. This manual contains instructions and tips for building and maintaining your new GT2. Please take a moment to read through it and familiarize yourself with the steps.

GT2

1:10

Nitro Racing Truck

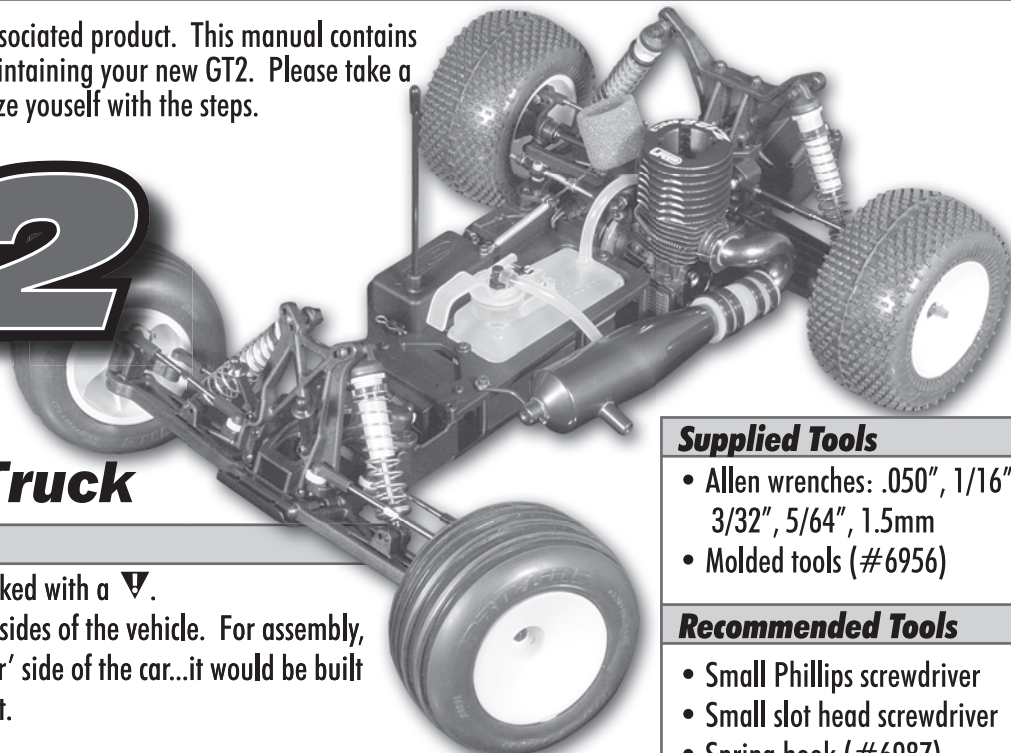

The Manual

- Special notes for each step will be marked with a ▼.
- Certain steps will notate left and right sides of the vehicle. For assembly, the left side of the vehicle is the 'driver' side of the car...it would be built as if you are sitting in the driver's seat.

The RTR

Your new RTR GT2 comes factory assembled, including radio gear. In this manual, any step that is RTR specific will be denoted with this symbol: **RTR**. You will need the following items to complete your RTR:

- Model car fuel
- 12 AA size batteries
- 1 D-size battery (for glow igniter)

The Kit

Your new GT2 kit requires assembly using this manual and recommended tools (some of which are included in the kit). In this manual, any step that is Factory Team specific will be denoted with this symbol: **FACTORY TEAM**. To complete this kit, you will need the following items:

- Glow plug igniter
- Glow plugs (AE #MC-59)
- Model car fuel & fuel bottle
- Receiver battery pack
- 12 AA size batteries
- Starter box (non-pullstart)
- R/C two channel surface frequency radio system
- .12/.15 c.i. rear exhaust/SG crank R/C engine w/rotary carb (strongly suggest)

Supplied Tools

- Allen wrenches: .050", 1/16", 3/32", 5/64", 1.5mm
- Molded tools (#6956)

Recommended Tools

- Small Phillips screwdriver
- Small slot head screwdriver
- Spring hook (#6987)
- 5/16" driver or glow plug wrench
- Locking adhesive (#1596)
- Filter Treatment (#7710)
- Super glue (CA)
- Ruler

Vehicle Options

7080: Factory Team GT2 Kit

- Hard anodized, PTFE-coated threaded shock bodies
- Full set of 20 bearings
- Black hard anodized aluminum chassis
- Blue aluminum shock bushings, front bulkhead, hinge pin brace, chassis brace, servo mounts and tuned pipe
- Blue titanium turnbuckles
- Dual disk slipper clutch
- Posi-lock rear wheel/axle setup
- Lightweight differential outdrives
- Pro-Line M2 Edge front tires/M3 Bowtie rear tires

7092: Ready-To-Run GT2

- Blue anodized aluminum shocks
- 14 ball bearings
- Blue anodized aluminum chassis
- Associated steel turnbuckles
- Dual disk slipper clutch
- AE .15 pull-start engine
- Custom printed body
- XP2 radio system
- Racing compound tires

Chassis Specs

7080: FT GT2 Kit

Length:	420mm
Width:	330mm
Wheelbase:	285mm
Internal Ratio:	4.09:1
Weight:	1850g (w/body)

GT2

Contacting Us

Associated Electrics, Inc.
3585 Cadillac Ave.
Costa Mesa, CA 92626 USA



<http://www.rc10.com> • <http://www.TeamAssociated.com>

Tel: 714.850.9342
Fax: 714.850.1744
Hours: 8am - 4pm, PST

Step 1

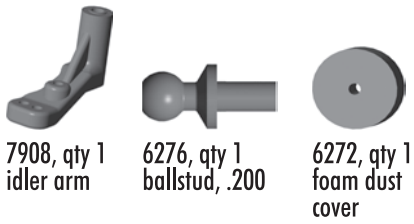

Step 2

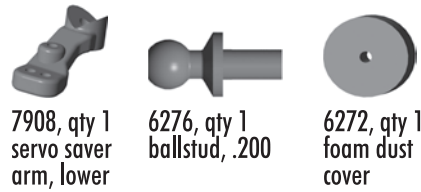

Step 3

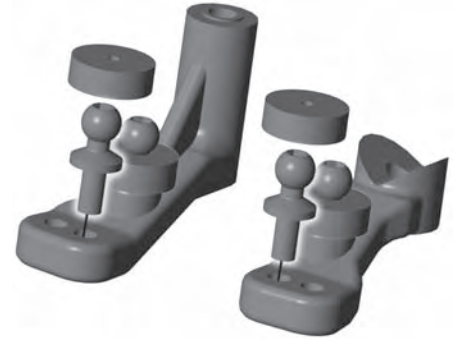
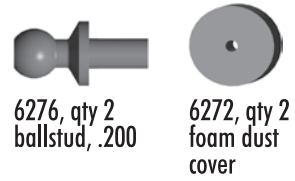

Step 4

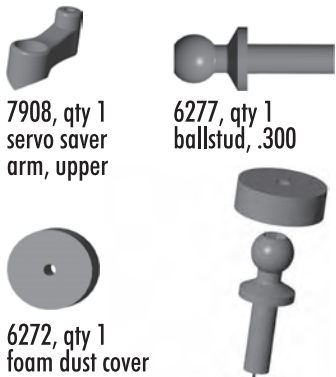

Step 5

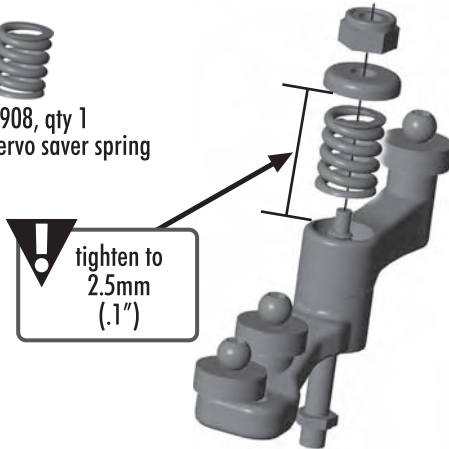
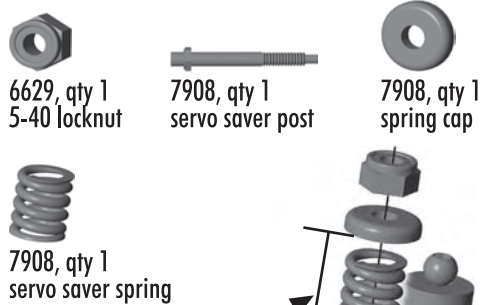

Step 6

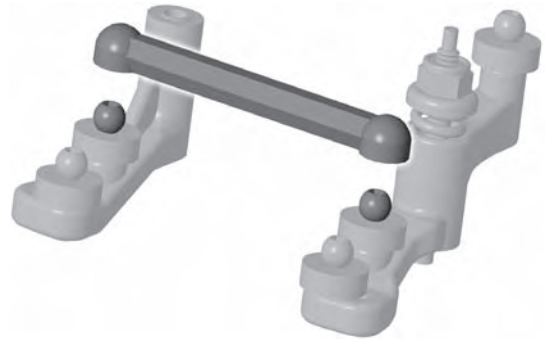

Step 7

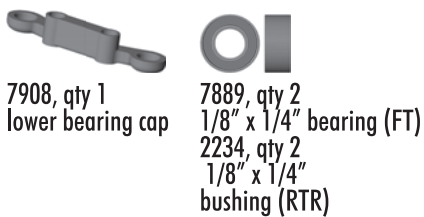

Step 8

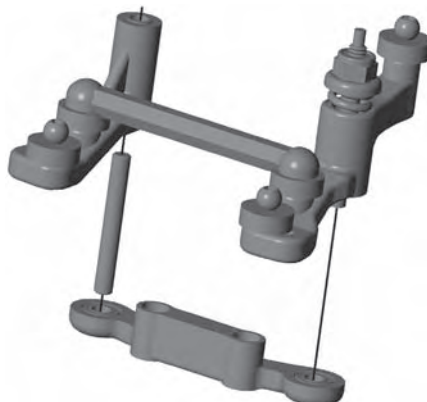

Step 9

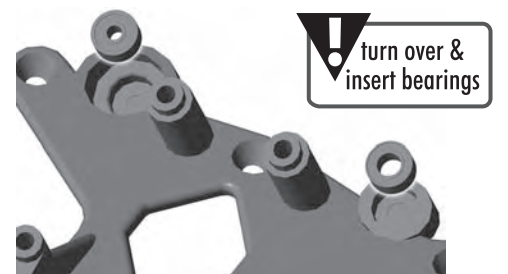
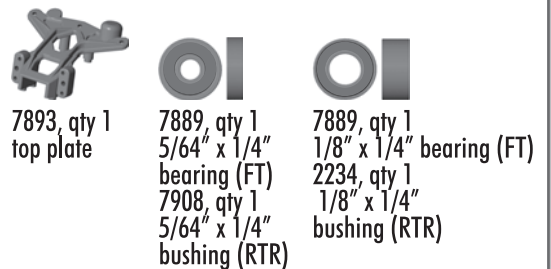

Step 10



6922, qty 2
4-40 x 1/2" fhcs

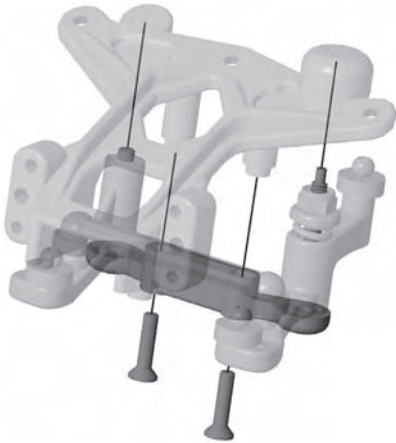

Step 11



7990, qty 1
aluminum front
bulkhead (FT)
9563, qty 1
front bulkhead
(RTR)



6915, qty 2
4-40 x 5/8" fhcs



7892, qty 1
qt2 front sub
chassis kickup

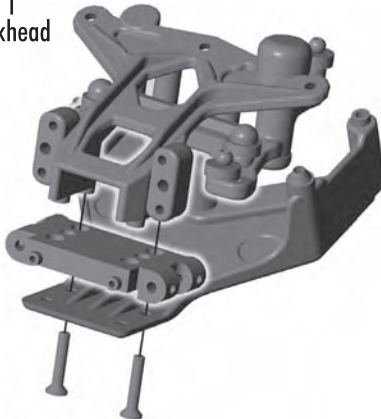

Step 12



6925, qty 3
4-40 x 1/2" shcs

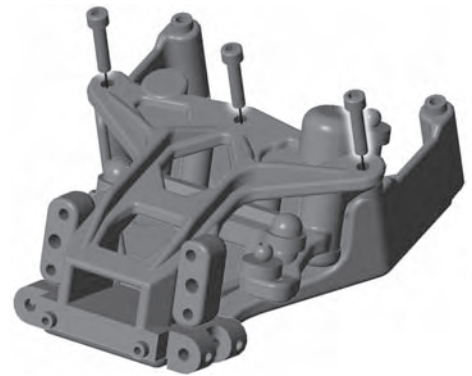

Step 13



7914, qty 1
front shock tower



6272, qty 2
foam dust cover



6277, qty 2
ballstud, .300



9630, qty 4
ballstud washer



Step 14



7413, qty 2
4-40 x 3/4" bhcs



7260, qty 2
plain nut (RTR)



1780, qty 2
aluminum shock
bushing (FT)
6473, qty 2
shock bushing (RTR)

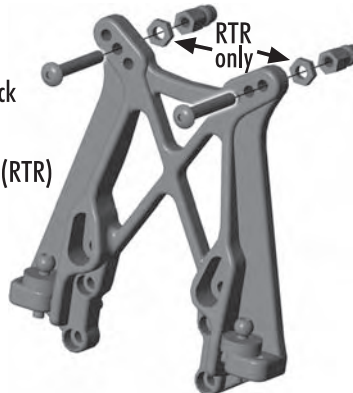

Step 15



6924, qty 2
4-40 x 3/8" shcs



7439, qty 2
front body mount



Step 16



6924, qty 4
4-40 x 3/8" shcs

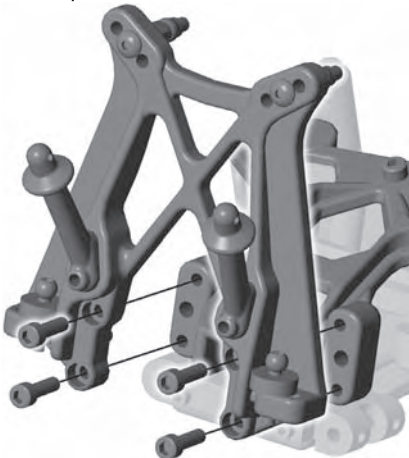

Step 17



7917, qty 2
front arm, 1 left
& 1 right



9645, qty 2
2-56 x 1/8" bhcs

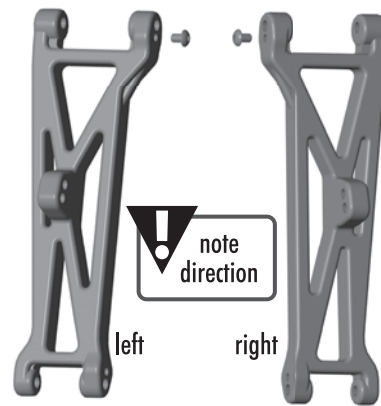

Step 18

9621, qty 2
inner hinge pin

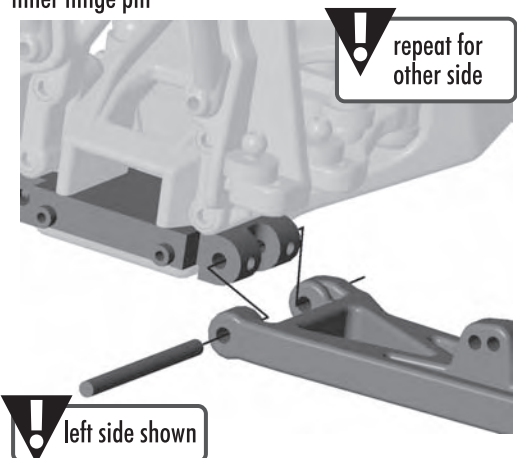

Step 19

- 9665, qty 1 aluminum hinge pin brace (FT)
- 9564, qty 1 hinge pin brace (RTR)
- 4334, qty 2 2-56 x 5/16" bhcs

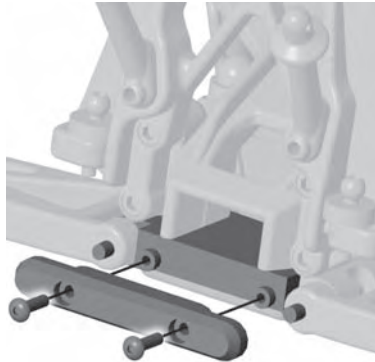

Step 20



- 7382, qty 4 4-40 setscrew

repeat for other side

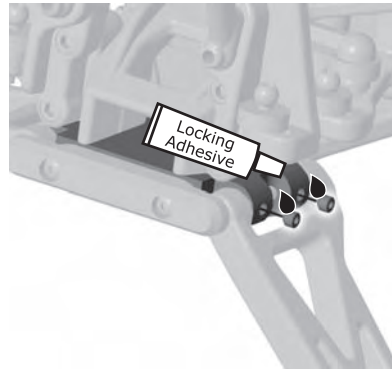

Step 21

- 7260, qty 2 plain nut
- 7921, qty 2 steering block 1 left & 1 right

repeat for right side



left side shown

Step 22

- 6299, qty 2 e-dip
- 7456, qty 2 trailing axle

repeat for right side

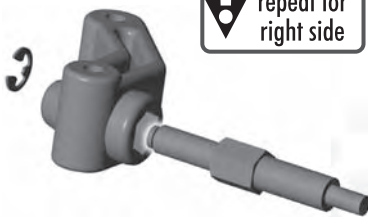

left side shown

Step 23

- 6272, qty 2 foam dust cover

repeat for right side

- 6277, qty 2 ballstud, .300

- 4187, qty 4 .030 washer

left side shown



Step 24

- 6272, qty 2 foam dust cover
- 3983, qty 2 ballstud, .300, black

repeat for right side

- 7919, qty 2 caster block, 25d, 1 left & 1 right

- 7260, qty 2 plain nut

left side shown

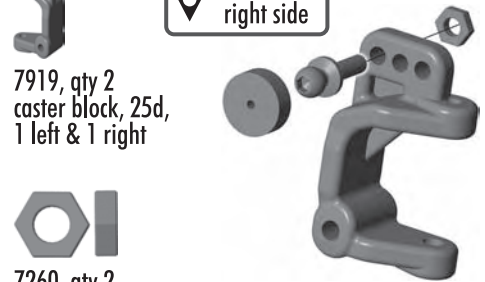

Step 25

- 9645, qty 2 2-56 x 1/8" bhcs
- 7927, qty 2 kingpin

- 4187, qty 4 .030 washer

repeat for right side

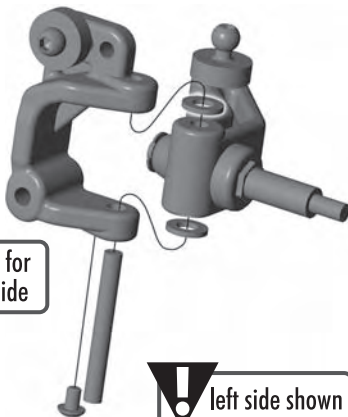

left side shown

Step 26

- 9645, qty 2 2-56 x 1/8" bhcs
- 7927, qty 2 outer hinge pin

repeat for right side

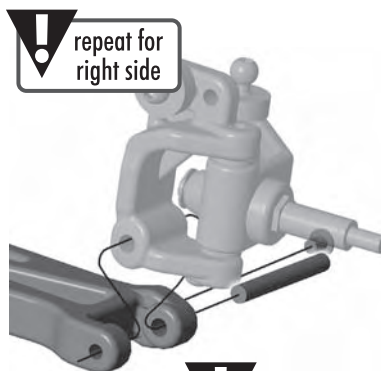

left side shown

Step 27

- 9562, qty 1 front bumper
- 6915, qty 2 4-40 x 5/8" fhcs

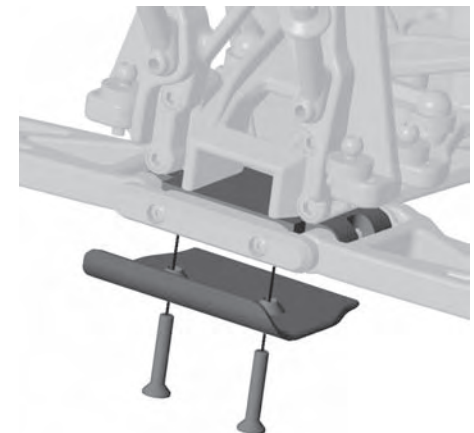

Step 287230, qty 4
ballcup1417, qty 2
2.80" ti turnbuckle (FT)
7101, qty 2
2.80" steel turnbuckle (RTR)

x2

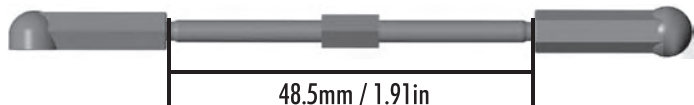

48.5mm / 1.91in

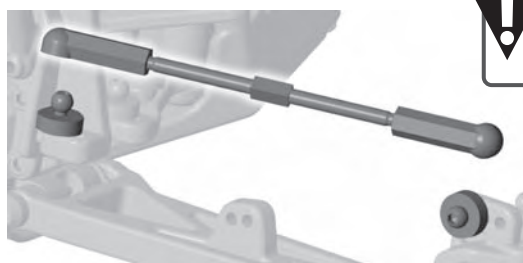
Front Camber Link repeat for
right side**Step 29**7230, qty 4
ballcup1408, qty 2
2.65" ti turnbuckle (FT)
7253, qty 2
2.62" steel turnbuckle (RTR)

x2

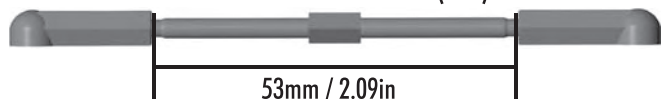

53mm / 2.09in

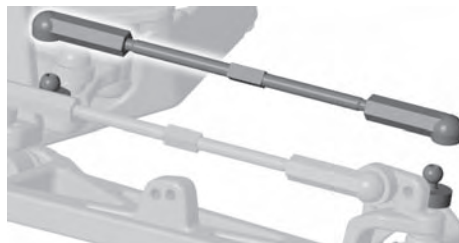
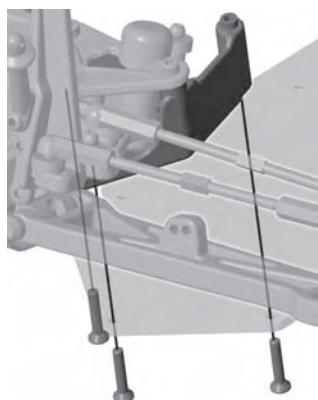
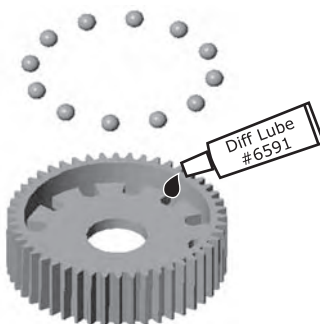
Steering Link repeat for
right side**Step 30**6922, qty 3
4-40 x 1/2" fhcs7991, qty 1
hard anodized chassis (FT)
7890, qty 1
blue anodized chassis (RTR)**Step 1**7664, qty 1
diff gear, 52t6581, qty 12
3/32 carbide diff
balls**Bag B - Differential****Step 2**1766, qty 1
diff outdrive hub,
lightened, right (FT)
7667, qty 1
diff outdrive hub,
right (RTR)7666, qty 2
diff ring1766, qty 1
diff outdrive hub,
lightened, left (FT)
7668, qty 1
diff outdrive hub,
left (RTR)**Step 3**6573, qty 2
thrust washer6574, qty 6
5/64 diff thrust ball6575, qty 1
diff thrust bolt Black Grease
#6588**Step 4** right side
diff half**Step 5**6589, qty 2
5/32" x 5/16"
ball bearing (FT)
6597, qty 2
5/32" x 5/16"
bushing (RTR)**Step 6**6575, qty 1
locking t-nut6582, qty 1
diff thrust spring pre-compress
spring

Step 1

6575, qty 1
diff bolt cover

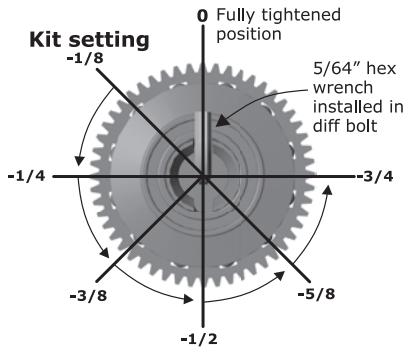

! When fully compressed, set at 1/8 turn out (see diagram). Re-check after initial run.

Step 1



7945, qty 1
transmission case,
left & right



3976, qty 2
3/8" x 5/8"
ball bearing



3977, qty 2
3/16" x 3/8"
ball bearing

Bag C - Transmission

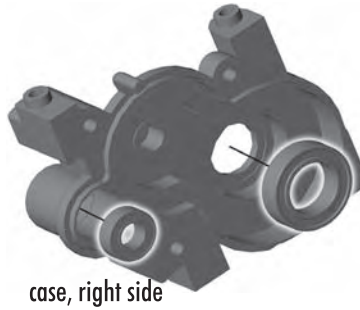

case, right side

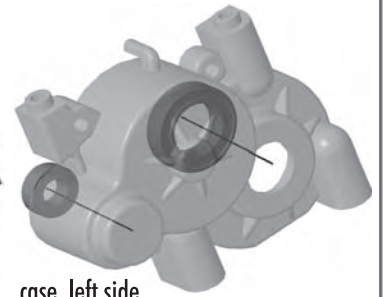

case, left side

Step 2



3977, qty 2
3/16" x 3/8"
ball bearing



7963, qty 1
idler gear cluster,
44-28

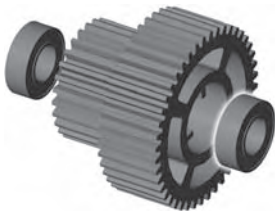

Step 3



7960, qty 1
top shaft

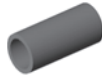

7961, qty 1
top shaft spacer



Step 4



7964, qty 1
idler gear shaft

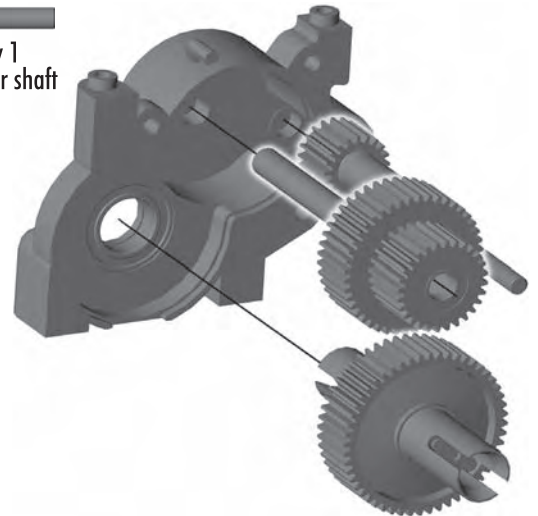

Step 5



6924, qty 2
4-40 x 3/8" shcs



6925, qty 1
4-40 x 1/2" shcs

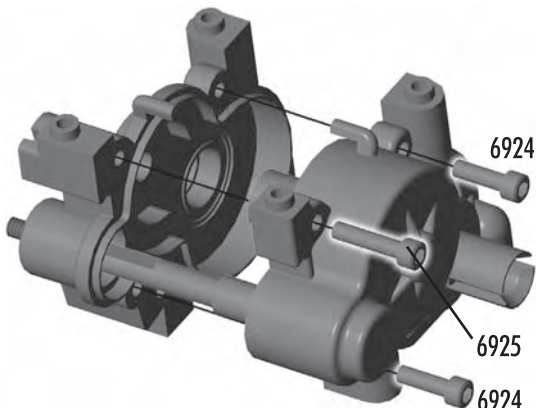

Step 6

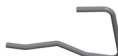

7948, qty 1
brake cam



7949, qty 2
brake pad



7950, qty 1
brake disc



7947, qty 2
brake top hat bushing



7633, qty 2
4-40 x 5/8" bhcs

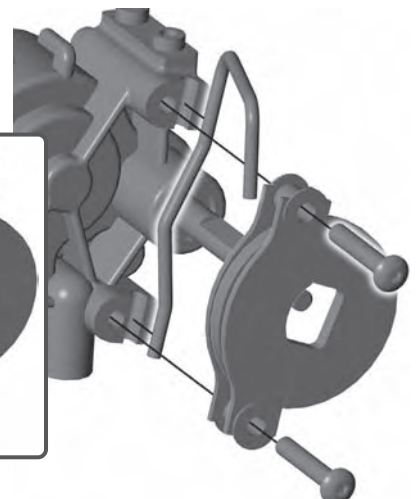
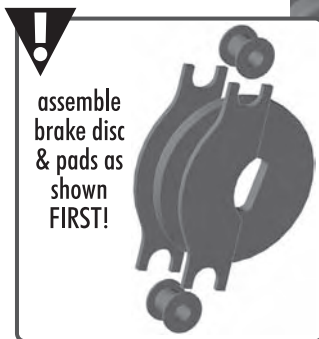

Step 7



7953, qty 1
slipper plate, inner

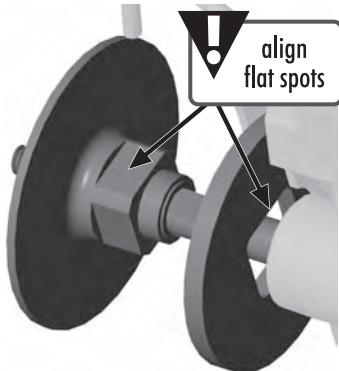
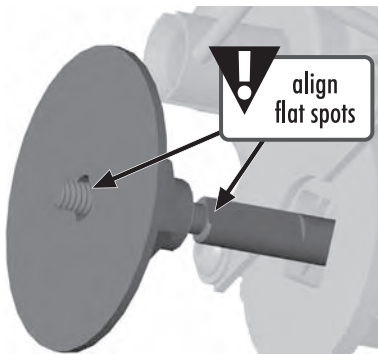

Step 8



9603, qty 2
slipper pad

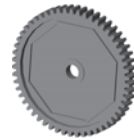

7955, qty 1
54t spur gear

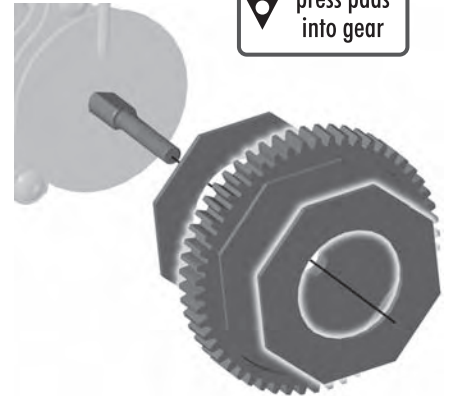

Step 9



9604, qty 1
slipper plate, outer



9605, qty 1
slipper spring



6629, qty 1
5-40 locknut



Step 1



7413, qty 2
4-40 x 3/4" bhcs



1781, qty 2
aluminum shock
bushing, short (FT)
6473, qty 2
shock bushing (RTR)



7940, qty 1
rear shock
tower



7260, qty 2
plain nut
(RTR)



Bag D - Rear End

Step 2



6926, qty 2
4-40 x 5/8" shcs



9273, qty 2
1/8" x 1/4" spacer



7941, qty 1
camber link
mount

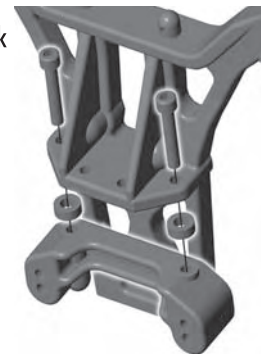

Step 3



1777, qty 4
aluminum pivot
ball end (FT)
7217, qty 4
pivot ball end (RTR)



7217, qty 4
shock end



1419, qty 2
3.0" ii turnbuckle (FT)
7937, qty 2
3.0" steel turnbuckle (RTR)

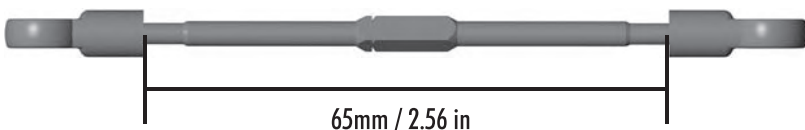
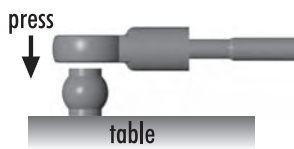

Step 4





6927, qty 2
4-40 x 3/4" shcs

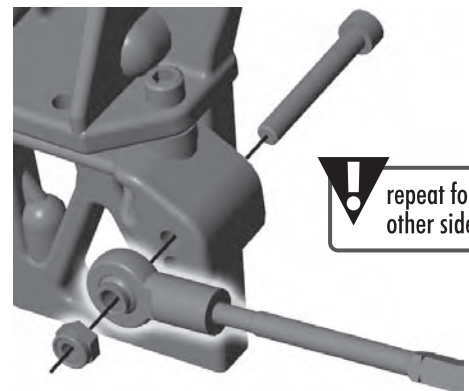

4449, qty 2
4-40 x 3/16" locknut



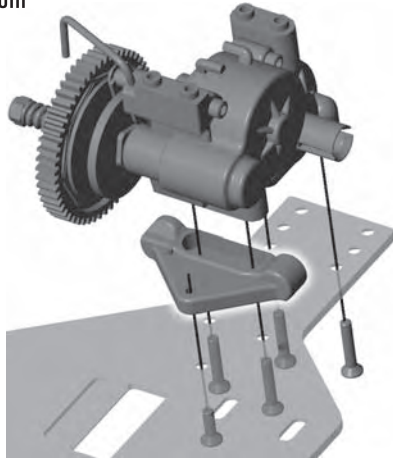

Step 5

-  7928, qty 1 rear arm mount
-  6915, qty 4 4-40 x 5/8" fhc
-  6292, qty 1 4-40 x 3/8" fhc



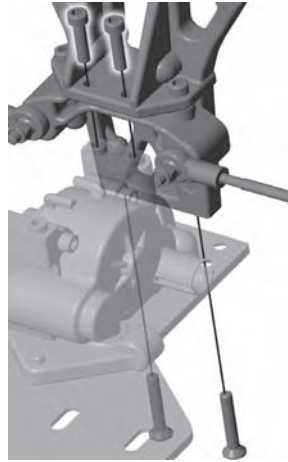

Step 6

-  6925, qty 2 4-40 x 1/2" shcs
-  6915, qty 2 4-40 x 5/8" fhc



Step 7

-  9621, qty 2 rear inner hinge pin
-  7930, qty 2 rear arms, 1 left & 1 right

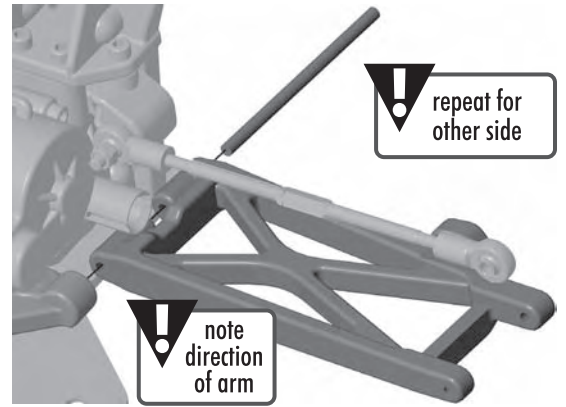

Step 8

-  7928, qty 1 arm mount (3+2)

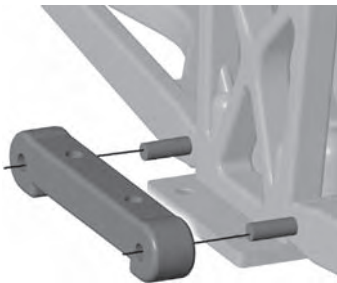

Step 9

-  7904, qty 1 battery box bottom
-  7260, qty 2 4-40 small pattern nut

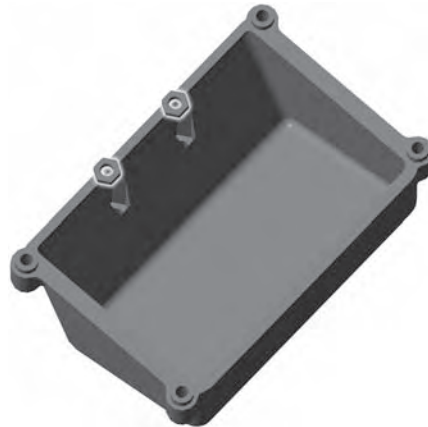

Step 10

-  7928, qty 1 rear arm mount shim
-  6923, qty 2 4-40 x 3/4" fhc

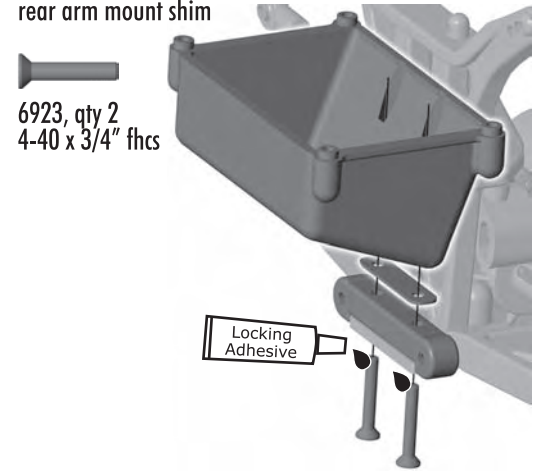

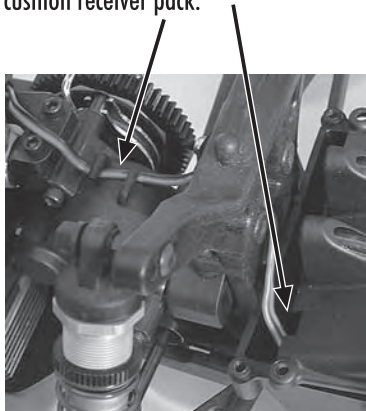

Step 11

Install receiver pack as shown. Note wire opening in receiver pack lid and wire hooks in transmission case.
TIP: Add foam padding (not included) to cushion receiver pack.



Step 12

-  6925, qty 6 4-40 x 1/2" shcs
-  7904, qty 1 battery box top

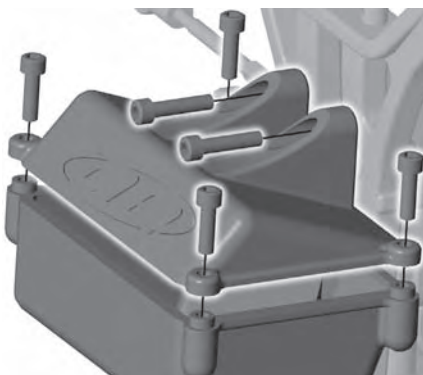

Step 13

-  7381, qty 2 cvd coupler
-  7381, qty 2 cvd cross pin
-  7381, qty 2 4-40 setscrew

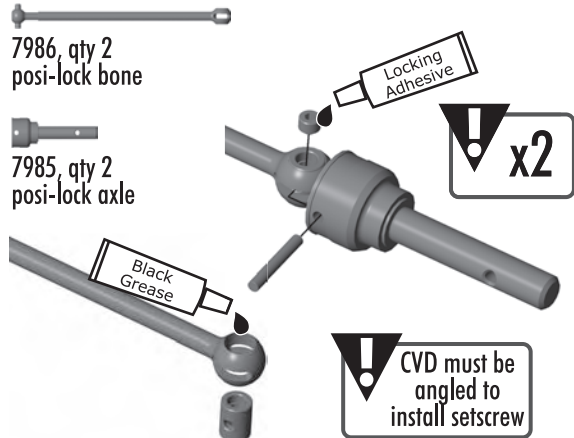

Step 14

- 7932, qty 2 hub carrier, 1.5d 1 left & 1 right
- 7935, qty 2 3/16" x 1/2" bearing
- 7933, qty 2 crush tube
- 3977, qty 2 3/16" x 3/8" bearing

- 9670, qty 2 axle (RTR)
- 5407, qty 2 red o-ring (RTR)
- 7462, qty 2 dogbone (RTR)



Step 15

- 9645, qty 2 2-56 x 1/8" bhcs
- 7927, qty 2 outer hinge pin
- 9273, qty 4 1/8" x 1/4" spacer

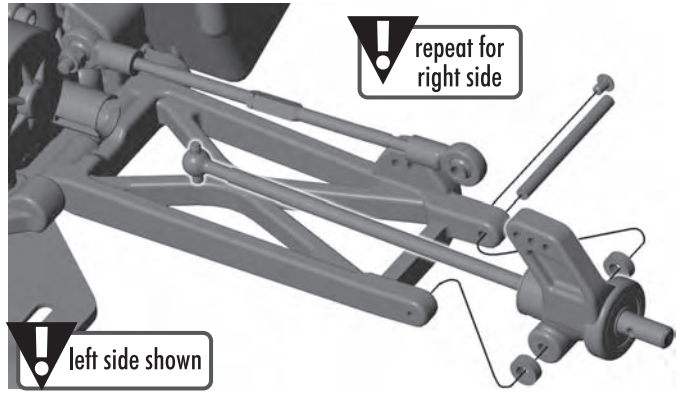

Step 16

RTR

- 9645, qty 2 2-56 x 1/8" bhcs
- 7927, qty 2 outer hinge pin
- 9273, qty 4 1/8" x 1/4" spacer
- 5407, qty 2 red o-ring

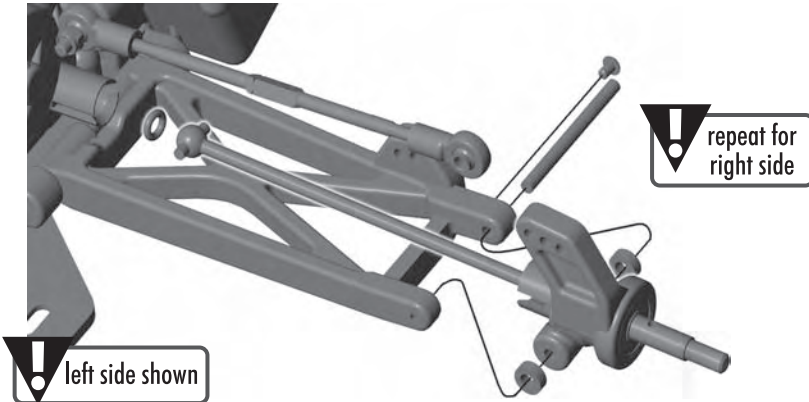

Step 17

- 6926, qty 2 4-40 x 5/8" shcs
- 9630, qty 2 .030 washer
- 7260, qty 2 3/16" plain nut

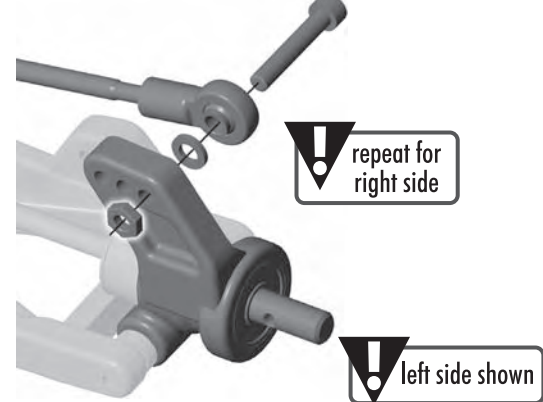

Step 18

FACTORY TEAM

- 7981, qty 2 posi-lock hub

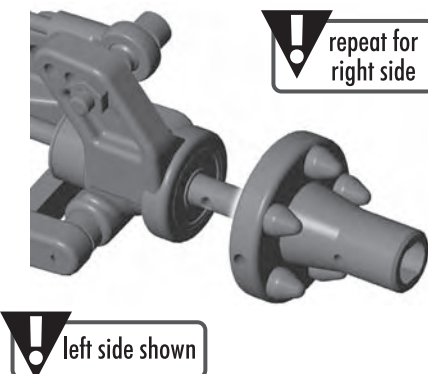

Step 19

FACTORY TEAM

- 7983, qty 4 4-40 setscrew
- 7983, qty 2 1/2" dowel pin

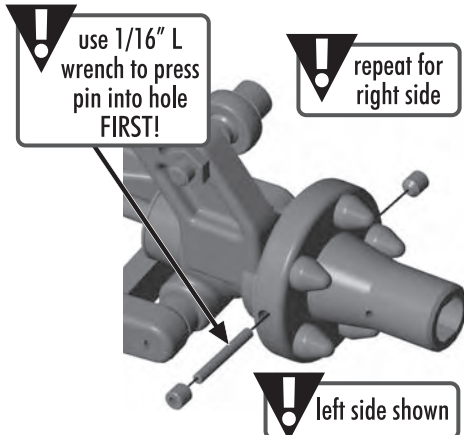

Step 20

RTR

- 7369, qty 2 universal axle pin
- 7368, qty 4 3/16" axle shims
- 9608, qty 2 rear axle wheel spacer

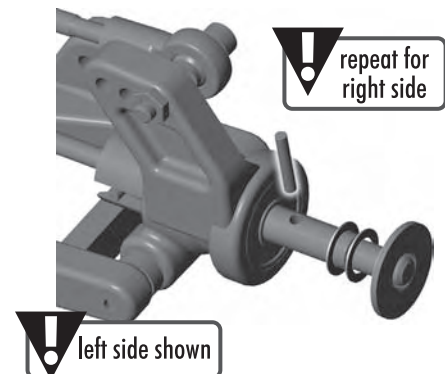

Step 21



7982, qty 2
posi-lock lever



7982, qty 2
posi-lock spring



7369, qty 2
axle pin

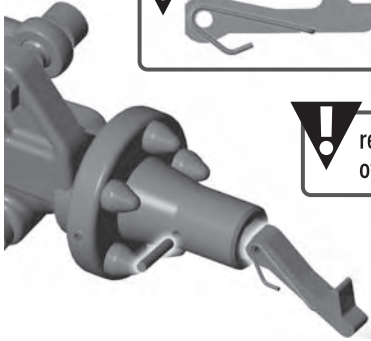

Steering Servo Chart*

*Not all servo's are listed.

	#7336 Spacer	#9180 Servo Arm
Airtronics 94102	no spacer	A
Airtronics 94738, 94157, 94158, 94257, 94258, 94357, 94358, 94452, 94453, 94751, 94755	thick spacer	A
Hitec HS-5625MG, HS-5645MG, HS625MG, HS645MG	no spacer	H
Hitec HS-303, HS-300BB, HS-945MG, HS-925MG, HS- 5945MG, HS-5925MG, HS-525MG, HS-525BB, HS-425BB, HS-422	thin spacer	H
JR Z4725, Z4750, Z2750, Z8450, Z8550, NES-4750	no spacer	J
JR Z250, Z550	thin spacer	J
Futaba S9204, S9250, S9450, S148	no spacer	F
Futaba S3003, S9202, S9101	thin spacer	F
Futaba S9404	thick spacer	F
KO PS-401, PS-2001, PS-2004, PS-2015, PS-2173, PS-2174, PS-2123, PS-2143, PS-2144	thin spacer	J

Bag E - Radio Tray

Step 1



3981, qty 1
ballstud, .200,
black



9180, qty 1
servo horn

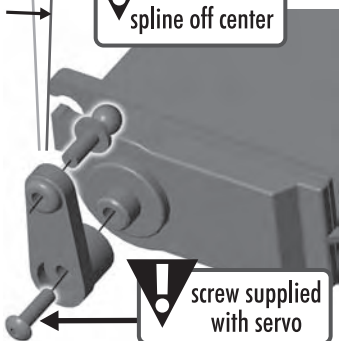

Step 2



6917, qty 4
4-40 x 3/8" bhcs



7337, qty 4
shim washers



7336, qty 2
servo mount
spacers



1779, qty 2
aluminum
servo mounts (FT)
7336, qty 2
servo mounts (RTR)

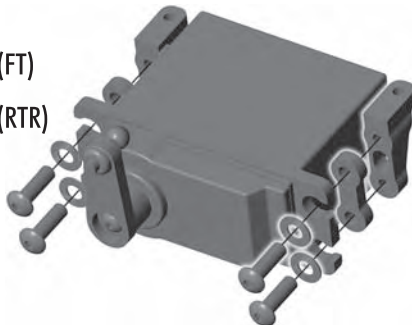

Step 3



6917, qty 2
4-40 x 3/8" bhcs



7894, qty 1
radio tray

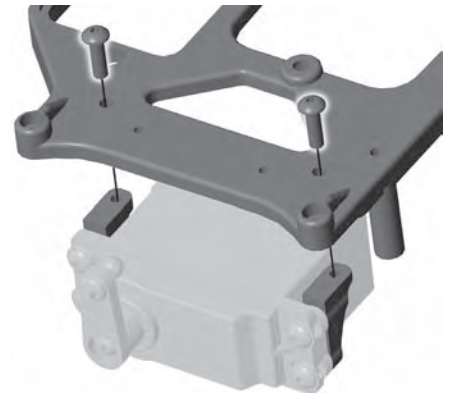

Step 4



6924, qty 4
4-40 x 3/8" shcs



7337, qty 4
shim washers

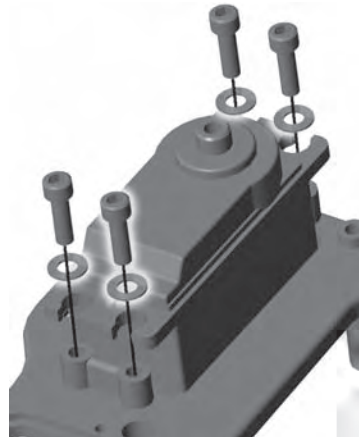

Step 5



9146, qty 2
2-56 x 3/16" bhcs



7896, qty 1
radio box (bottom)

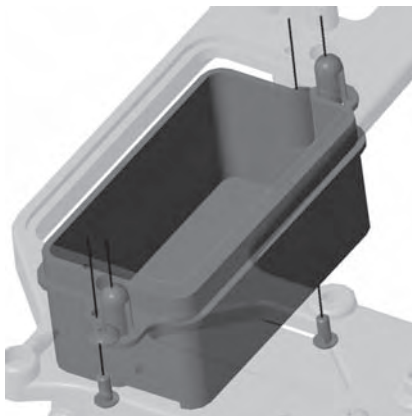

Step 6

